



TRANSLAS [®]
DUTCH TORCH TECHNOLOGY

TIG

ULTRA ERGONOMIC DESIGN





ABOUT TRANSLAS

Translas is a Dutch manufacturer of welding guns since 1960. A company founded by welders, for welders with a passion for innovation and new technologies, continually strives to engineer innovative products that boast a distinctive design, quality, and functionality.

Welder's safety is of paramount importance to Translas. The company's goal is to globally reduce welders' exposure to hazardous fumes and provide a healthier and safer work environment. Some of the pioneering products include extractor guns with a built-in module to safely extract welding fumes at the source and portable extraction units for high-performance extraction.

www.translas.com

TABLE OF CONTENTS

ABOUT TRANSLAS	2
8XT TIG TORCHES	5
TIG WEAR PARTS - COLLETS	40
TIG WEAR PARTS - COLLETS BODIES	42
TIG WEAR PARTS - GAS LENSES	43
TIG WEAR PARTS - CERAMIC CUPS	44
TIG WEAR PARTS - CERAMIC GAS LENS CUPS	45
8XT SWITCH MODEL OPTION	46
8XT SWITCH CABLE ENDS	48
EARTH CLAMPS - CABLE CONNECTORS	49
ELECTRODE HOLDERS - TUNGSTEN ELECTRODES	50



TIG TORCHES Catalogue

Scan the QR code with your smart phone



A welder is working on a large industrial structure, likely a ship's hull or a large building component. The welder is positioned in an orange lift basket, which is extended from a crane. The welder is using a TIG torch to weld a metal beam. Bright sparks are flying from the welding point, illuminating the scene. The background shows the complex steel framework of the structure under construction.

TRANSLAS TIG TORCHES

There is nothing ordinary about the TIG torches of Translas. They are top of the line.

With high-quality and high-reliability torches, these torches offer the best combination of price and quality. As well as the welding comfort provided by the Translas TIG torch, the smart arrangement of the torch is another benefit.

TRANSLAS [®]
DUTCH TORCH TECHNOLOGY

TIG

8XT TIG TORCH





8XT TIG TORCHES

TIG
TORCHES



8XT TIG



DESIGN

The design of the 8XT TIG handle is made together with the 8XM MIG series. Therefore both lines have similar features and are familiar in their use.

THE CONCEPT

The 8XT TIG torch line from Translas offers high comfort due to its ultra-ergonomic design. The 8XT handle is packed with ergonomic features to provide the best comfort for the hand of the welder and to eliminate any tension on the wrist and fingers.

HIGH-QUALITY



- A** Switch system that keeps dirt and water away from the PCB.
- B** Vertically curved front cap with grip lines for comfortable and stable pen grip
- C** Single-screw quick and easy (dis)assembly of the whole handle.





ERGONOMIC DESIGN

8XT HANDLE

The 8XT TIG torch line from Translas offers high comfort due to its ultra-ergonomic handle design.

FLEXIBLE

Based on the insights received by welders, we designed a torch it is a pleasure to work with. In the same time, it is flexible enough for our dealers due to its many switch options and private label possibilities.

ERGONOMIC BUMP

The nose cap has a unique ergonomic bump that lies perfectly on the curve between the thumb and index finger. The handle can be executed also with a flat cap if preferred.



PERFECT MACHINE CONTACT

Unique gold-plated spring contacts inside the switch module ensure perfect connection with the welding machine.

2K SOFT RUBBER GRIP

2K grip on the bottom cap, made of soft TPE rubber, give great stability while holding the torch in any position.



HIGH-RELIABILITY



8XT TIG TORCH LINE



HIGH-QUALITY

8XT TIG TORCH



8XT 9 

AIR COOLED
 DC - 110 AMP
 AC/DC - 80 AMP
 Duty Cycle - 35%

8XT TIG TORCH



8XT 17 

AIR COOLED
 DC - 140 AMP
 AC/DC - 100 AMP
 Duty Cycle - 35%

8XT TIG TORCH



8XT 18 

WATER COOLED
 DC - 320 AMP
 AC/DC - 230 AMP
 Duty Cycle - 100%

8XT TIG TORCH



8XT 18SC 

WATER COOLED
 DC - 400 AMP
 AC/DC - 280 AMP
 Duty Cycle - 100%



8XT TIG TORCH LINE

TIG TORCHES



**8XT
20**



WATER COOLED

DC - 220 AMP

AC/DC - 165 AMP

Duty Cycle - 100%

8XT TIG TORCH



**8XT
24**



AIR COOLED

DC - 80 AMP

AC/DC - 60 AMP

Duty Cycle - 35%

8XT TIG TORCH



**8XT
24W**



WATER COOLED

DC - 210 AMP

AC/DC - 165 AMP

Duty Cycle - 100%

8XT TIG TORCH



**8XT
25F**



WATER COOLED

DC - 250 AMP

AC/DC - 175 AMP

Duty Cycle - 100%

8XT TIG TORCH

HIGH-RELIABILITY



8XT TIG TORCH LINE

TIG TORCHES

HIGH-QUALITY



8XT TIG TORCH



8XT 26 

AIR COOLED
 DC - 180 AMP
 AC/DC - 130 AMP
 Duty Cycle - 35%

8XT TIG TORCH



8XT 28 

AIR COOLED
 DC - 300 AMP
 AC/DC - 250 AMP
 Duty Cycle - 35%

8XT TIG TORCH



8XT 30 

WATER COOLED
 DC - 320 AMP
 AC/DC - 230 AMP
 Duty Cycle - 100%



8XT TIG TORCH LINE

TIG
TORCHES

8XT TIG TORCH



8XT 121 

AIR COOLED

DC - 160 AMP
AC/DC - 120 AMP
Duty Cycle - 35%

8XT TIG TORCH



8XT 301 

WATER COOLED

DC - 350 AMP
AC/DC - 250 AMP
Duty Cycle - 100%

8XT TIG TORCH



8XT 450 

WATER COOLED

DC - 450 AMP
AC/DC - 360 AMP
Duty Cycle - 100%

HIGH-RELIABILITY



8XT - 9 TIG TORCH

DC - 110 AMP, AC/DC - 80 AMP, DUTY CYCLE - 35%



AIR COOLED

HIGH-QUALITY

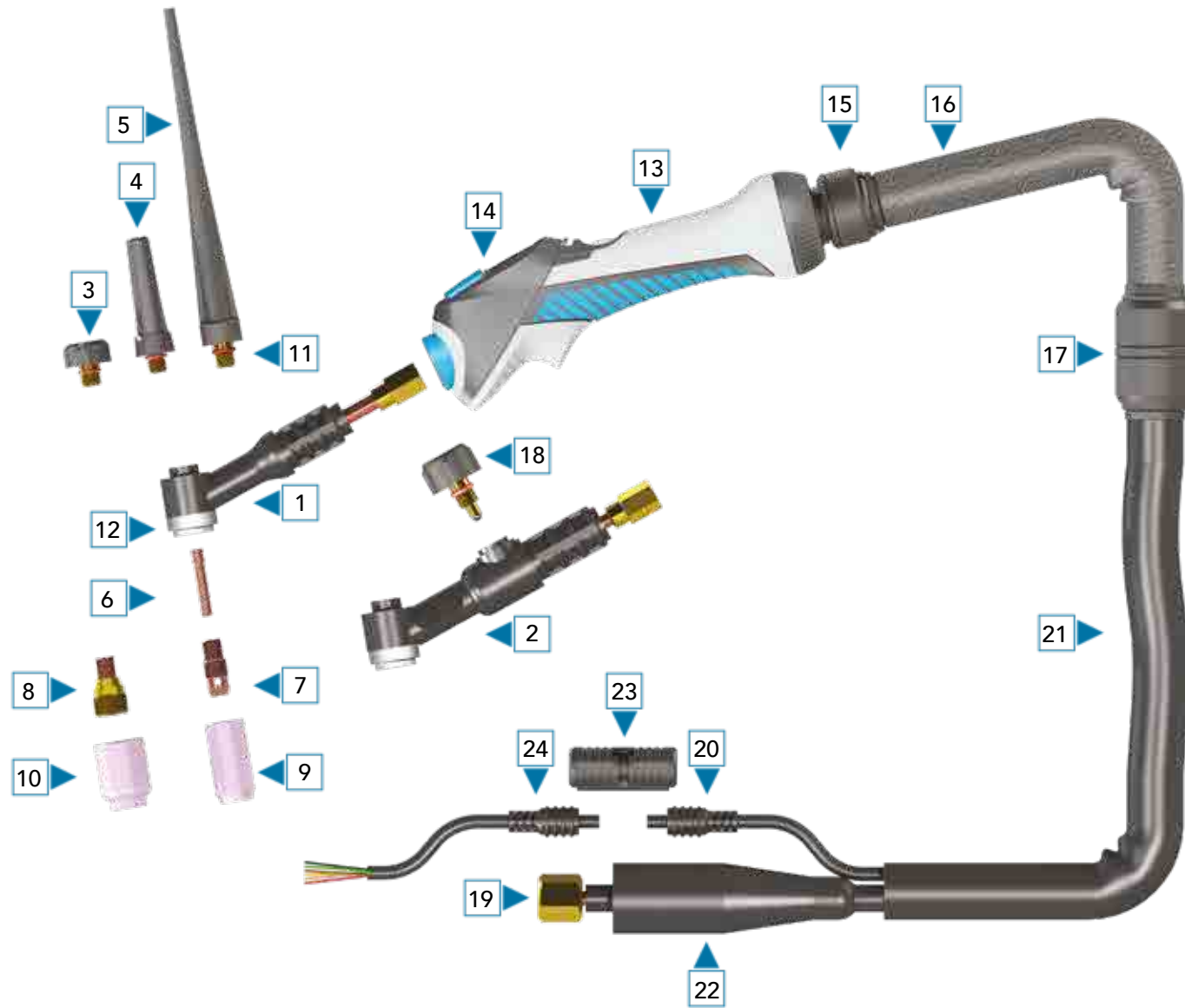

ITEM	PART NO.	DESCRIPTION	PACK QTY
COMPLETE TORCHES			
-	8X10010004000	8XT-9 Tig torch 4mtr M12x1	1
-	8X10010004210	8XT-9 Tig torch 4mtr 1/4'G	1
-	8X10010004220	8XT-9 Tig torch 4mtr 3/8'G	1
-	8X10013504400	8XT-9 Tig torch 4mtr 10-25mm ² (2PC)	1
-	8X1100360440X	8XT-9V Tig torch 4mtr 10-25mm ² (2PC)	1
-	8X10010008000	8XT-9 Tig torch 8mtr M12x1	1
-	8X10010008210	8XT-9 Tig torch 8mtr 1/4'G	1
-	8X10010008220	8XT-9 Tig torch 8mtr 3/8'G	1
-	8X10013508400	8XT-9 Tig torch 8mtr 10-25mm ² (2PC)	1
-	8X1100360840X	8XT-9V Tig torch 8mtr 10-25mm ² (2PC)	1
Other connections available on request			

ITEM	PART NO.	DESCRIPTION	PACK QTY
SPARE PARTS			
1	520100	Torch body standard	1
	520105	Torch body flexible	1
2	520110	Torch body valve	1
3	500342	41V33 Back cap short	5
4	500344	41V35 Back cap medium	5
5	500340	41V24 Back cap long	5
6	500658	13N23 Collet 2,4mm	5
Other collets see Page 40			
7	500758	13N28 Collet body 2,4mm	5
Other collets body see Page 42			
8	500828	45V44 Gas lens 2,4mm	5
Other Gas lens see Page 43			
9	500504	13N10 Ceramic cup 9,5mm Gr. 6	10
Other Ceramic cup see Page 44			
10	500564	53N60 Ceramic gas lens cup 9,5mm Gr. 6	10
Other Ceramic gas lens cup see Page 45			



ITEM	PART NO.	DESCRIPTION	PACK QTY
SPARE PARTS			
11	500360	98W77 O-ring	25
12	500400	598882 Heat shield	5
13	8X9900	8XT Handle complete with 1-button switch	1
14	8X9510	8XT Switch module 1-button complete	1
Other Switch module see Page 46			
15	509200	Ball-and-socket joint with connection ring	2
16	453752	Leather sheating 23mm L=50cm	1
17	501293	Connection set (5-parts) for neoprene/leather 23mm	2
18	500370	VS917 Valve	2
19	S01000400	Power/gas cable 4mtr M12x1	1
	S01000421	Power/gas cable 4mtr 1/4'G	1
	S01000422	Power/gas cable 4mtr 3/8'G	1
	S01000800	Power/gas cable 8mtr M12x1	1
	S01000821	Power/gas cable 8mtr 1/4'G	1
	S01000822	Power/gas cable 8mtr 3/8'G	1
20	306550	Switch cable 4mtr (QuickConnect)	1
	306552	Switch cable 8mtr (QuickConnect)	1
21	453785	Neoprene sheating 23mm p/mtr	10
22	500890	Insulation boot	2
23	306545	Locking clip (QuickConnect)	1
24	306559	Switch cable end without plug (QuickConnect)	1
Other Switch cable end with plugs Page 48			

HIGH-RELIABILITY



8XT - 17 TIG TORCH

DC - 140 AMP, AC/DC - 100 AMP, DUTY CYCLE - 35%

AIR COOLED

HIGH-QUALITY

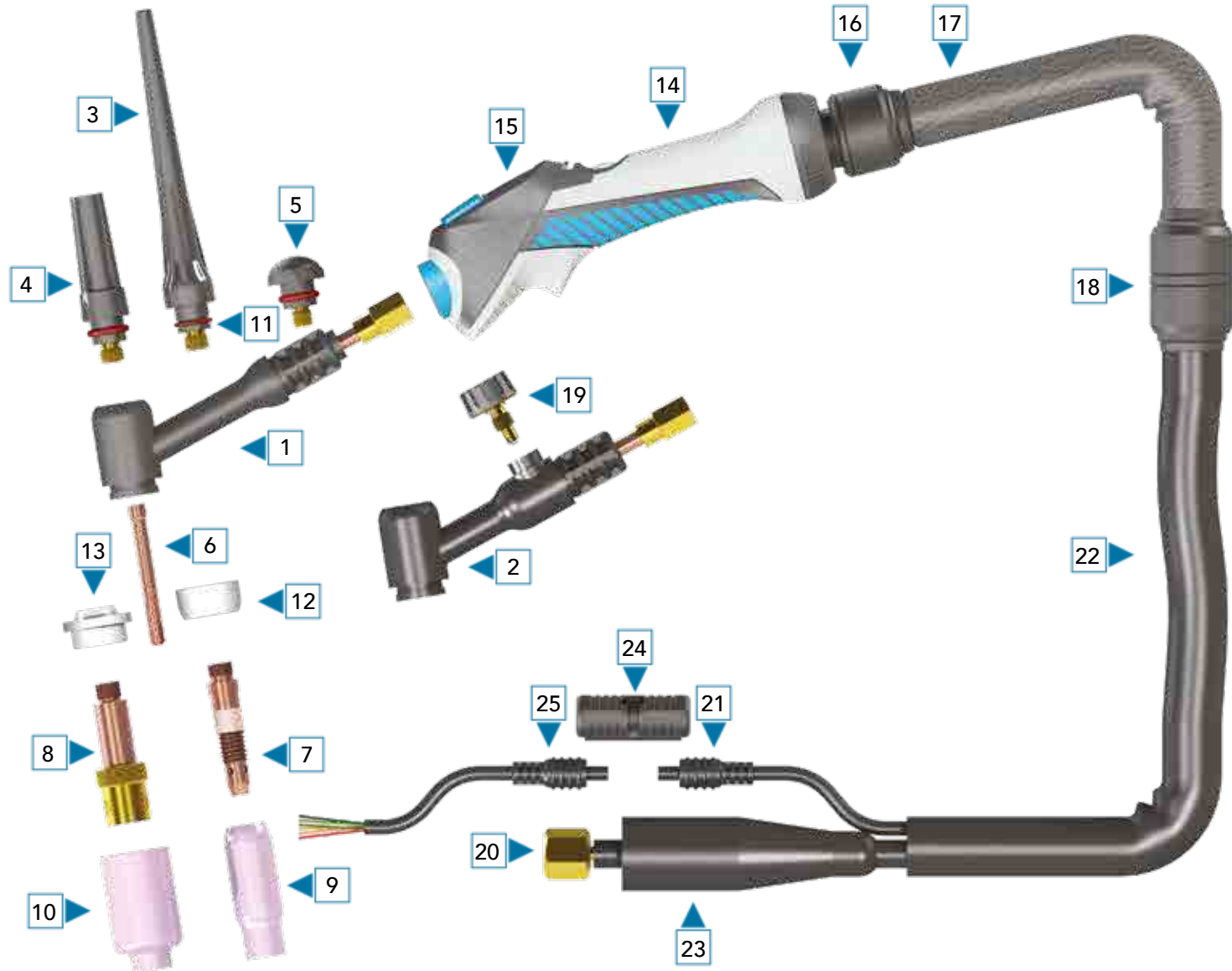

ITEM	PART NO.	DESCRIPTION	PACK QTY
COMPLETE TORCHES			
-	8X20010004000	8XT-17 Tig torch 4mtr M12x1	1
-	8X20010004210	8XT-17 Tig torch 4mtr 1/4'G	1
-	8X20010004220	8XT-17 Tig torch 4mtr 3/8'G	1
-	8X20013504400	8XT-17 Tig torch 4mtr 10-25mm ² (2PC)	1
-	8X20013504500	8XT-17 Tig torch 4mtr 35-50mm ² (2PC)	1
-	8X2100360440X	8XT-17V Tig torch 4mtr 10-25mm ² (2PC)	1
-	8X2100360450X	8XT-17V Tig torch 4mtr 35-50mm ² (2PC)	1
-	8X20010008000	8XT-17 Tig torch 8mtr M12x1	1
-	8X20010008210	8XT-17 Tig torch 8mtr 1/4'G	1
-	8X20010008220	8XT-17 Tig torch 8mtr 3/8'G	1
-	8X20013508400	8XT-17 Tig torch 8mtr 10-25mm ² (2PC)	1
-	8X20013508500	8XT-17 Tig torch 8mtr 35-50mm ² (2PC)	1
-	8X2100360840X	8XT-17V Tig torch 8mtr 10-25mm ² (2PC)	1
-	8X2100360850X	8XT-17V Tig torch 8mtr 35-50mm ² (2PC)	1
Other connections available on request			

ITEM	PART NO.	DESCRIPTION	PACK QTY
SPARE PARTS			
1	520200	Torch body standard	1
	520205	Torch body flexible	1
2	520210	Torch body valve	1
	520215	Torch body flexible/valve	1
3	500346	57Y02 Back cap long	5
4	500347	300M Back cap medium	5
5	500348	57Y04 Back cap short	5
6	500670	10N24 Collet 2,4mm	5
Other collets see Page 40			
7	500770	10N32 Collet body 2,4mm	5
Other collets body see Page 42			



ITEM	PART NO.	DESCRIPTION	PACK QTY
SPARE PARTS			
8	500836	45V26 Gas lens 2,4mm	5
Other Gas lens see Page 43			
9	500524	10N48 Ceramic cup 9,5mm Gr. 6	10
Other Ceramic cup see Page 44			
10	500584	54N16 Ceramic gas lens cup 9,5mm Gr. 6	10
Other Ceramic gas lens cup see Page 45			
11	500364	98W18 O-ring	25
12	500402	18CG Heat shield for collet body	5
13	500404	54N01 Heat shield for gas lens	5
14	8X9900	8XT Handle complete with 1-button switch	1
15	8X9510	8XT Switch module 1-button complete	1
Other Switch module see Page 46			
16	509200	Ball-and-socket joint with connection ring	2
17	453752	Leather sheating 23mm L=50cm	1
18	501293	Connection set (5-parts) for neoprene/leather 23mm	2
19	500370	VS917 Valve	2
20	S20000400	Power/gas cable 4mtr M12x1	1
	S20000421	Power/gas cable 4mtr 1/4'G	1
	S20000422	Power/gas cable 4mtr 3/8'G	1
	S20000800	Power/gas cable 8mtr M12x1	1
	S20000821	Power/gas cable 8mtr 1/4'G	1
	S20000822	Power/gas cable 8mtr 3/8'G	1
21	306550	Switch cable 4mtr (QuickConnect)	1
	306552	Switch cable 8mtr (QuickConnect)	1
22	453785	Neoprene sheating 23mm p/mtr	10
23	500890	Insulation boot	2
24	306545	Locking clip (QuickConnect)	1
25	306559	Switch cable end without plug (QuickConnect)	1
Other Switch cable end with plugs Page 48			

HIGH-RELIABILITY



8XT - 18 TIG TORCH

DC - 320 AMP, AC/DC - 230 AMP, DUTY CYCLE - 100%

TIG
TORCHES



WATER COOLED

HIGH-QUALITY

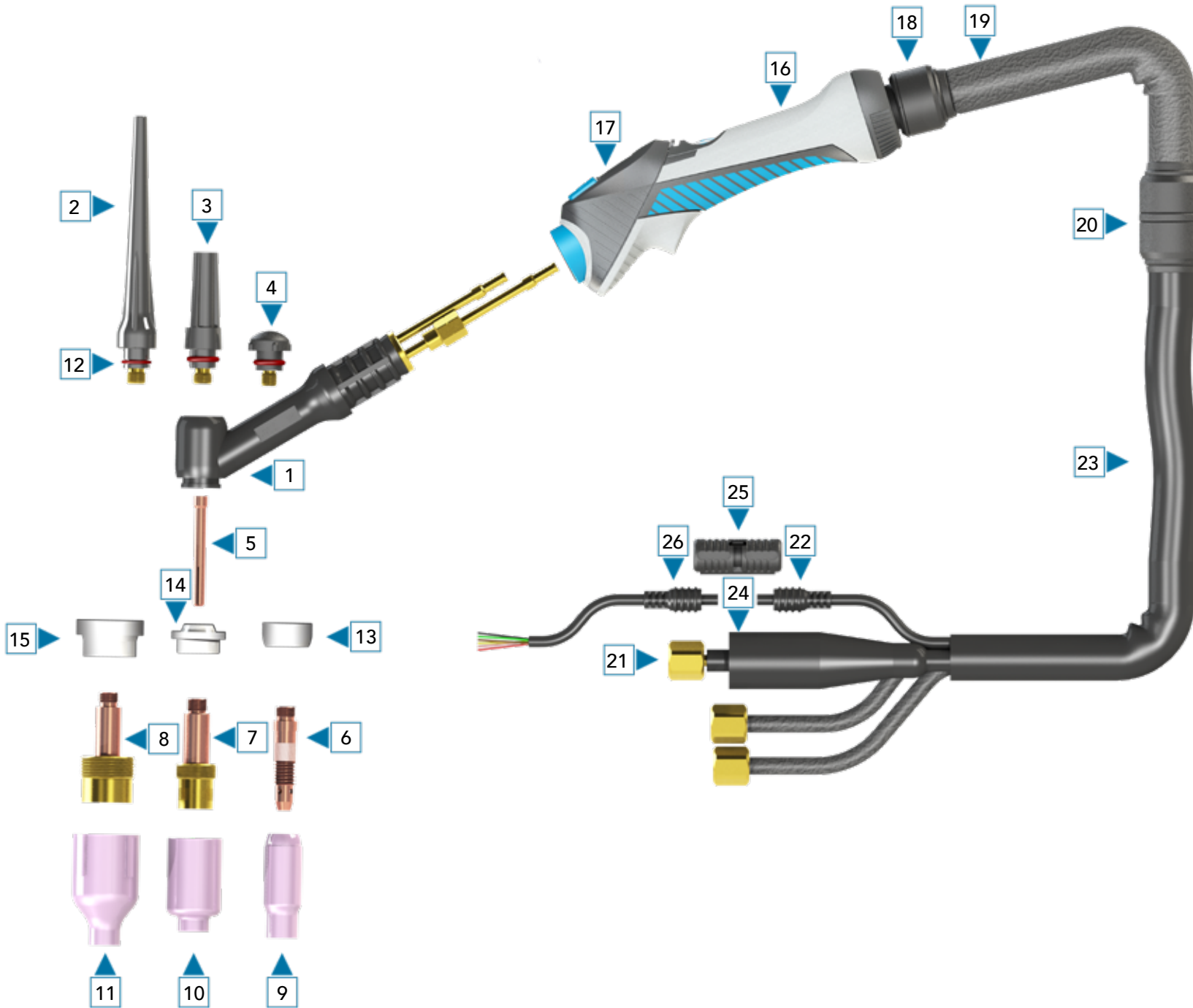

ITEM	PART NO.	DESCRIPTION	PACK QTY
COMPLETE TORCHES			
-	8X30014004600	8XT-18 Tig torch 4mtr M12x1	1
-	8X30014004800	8XT-18 Tig torch 4mtr 3/8'G	1
-	8X30014004650	8XT-18 Tig torch 4mtr 35-50mm ²	1
-	8X30014008600	8XT-18 Tig torch 8mtr M12x1	1
-	8X30014008800	8XT-18 Tig torch 8mtr 3/8'G	1
-	8X30014008650	8XT-18 Tig torch 8mtr 35-50mm ²	1
Other connections available on request			

ITEM	PART NO.	DESCRIPTION	PACK QTY
SPARE PARTS			
1	520300	Torch body standard	1
	520305	Torch body flexible	1
2	500346	57Y02 Back cap long	5
3	500347	300M Back cap medium	5
4	500348	57Y04 Back cap short	5
5	500670	10N24 Collet 2,4mm	5
Other collets see Page 40			
6	500770	10N32 Collet body 2,4mm	5
Other collets body see Page 42			
7	500836	45V26 Gas lens 2,4mm	5
8	500850	45V64 large gas lens 2,4mm	2
Other Gas lens see Page 43			



ITEM	PART NO.	DESCRIPTION	PACK QTY
SPARE PARTS			
9	500524	10N48 Ceramic cup 9,5mm Gr. 6	10
Other Ceramic cup see Page 44			
10	500584	54N16 Ceramic gas lens cup 9,5mm Gr. 6	10
11	500638	57N75 Ceramic large gas lens cup 9,5mm Gr. 6	5
Other Ceramic gas lens cup see Page 45			
12	500364	98W18 O-ring	25
13	500402	18CG Heat shield for collet body	5
14	500404	54N01 Heat shield for gas lens	5
15	500412	54N63 Heat shield for larage gas lens	5
16	8X9950	8XT Handle complete with 1-button switch	1
17	8X9510	8XT Switch module 1-button complete	1
18	509210	Ball-and-socket joint with connection ring	2
Other Switch module see Page 46			
19	453756	Leather sheating 27mm L=50cm	1
20	501298	Connection set (5-parts) for neoprene/leather 27mm	2
21	S30000400	Power/water cable 4mtr M12x1	1
	S30000422	Power/water cable 4mtr 3/8'G	1
	S30000800	Power/water cable 8mtr M12x1	1
	S30000822	Power/water cable 8mtr 3/8'G	1
22	306550	Switch cable 4mtr (QuickConnect)	1
	306552	Switch cable 8mtr (QuickConnect)	1
23	453780	Neoprene sheating 25 mm p/mtr	10
24	500890	Insulation boot	2
25	306545	Locking clip (QuickConnect)	1
26	306559	Switch cable end without plug (QuickConnect)	1
Other Switch cable end with plugs Page 48			

HIGH-RELIABILITY



8XT - 18SC TIG TORCH

DC - 400 AMP, AC/DC - 280 AMP, DUTY CYCLE - 100%



WATER COOLED

HIGH-QUALITY

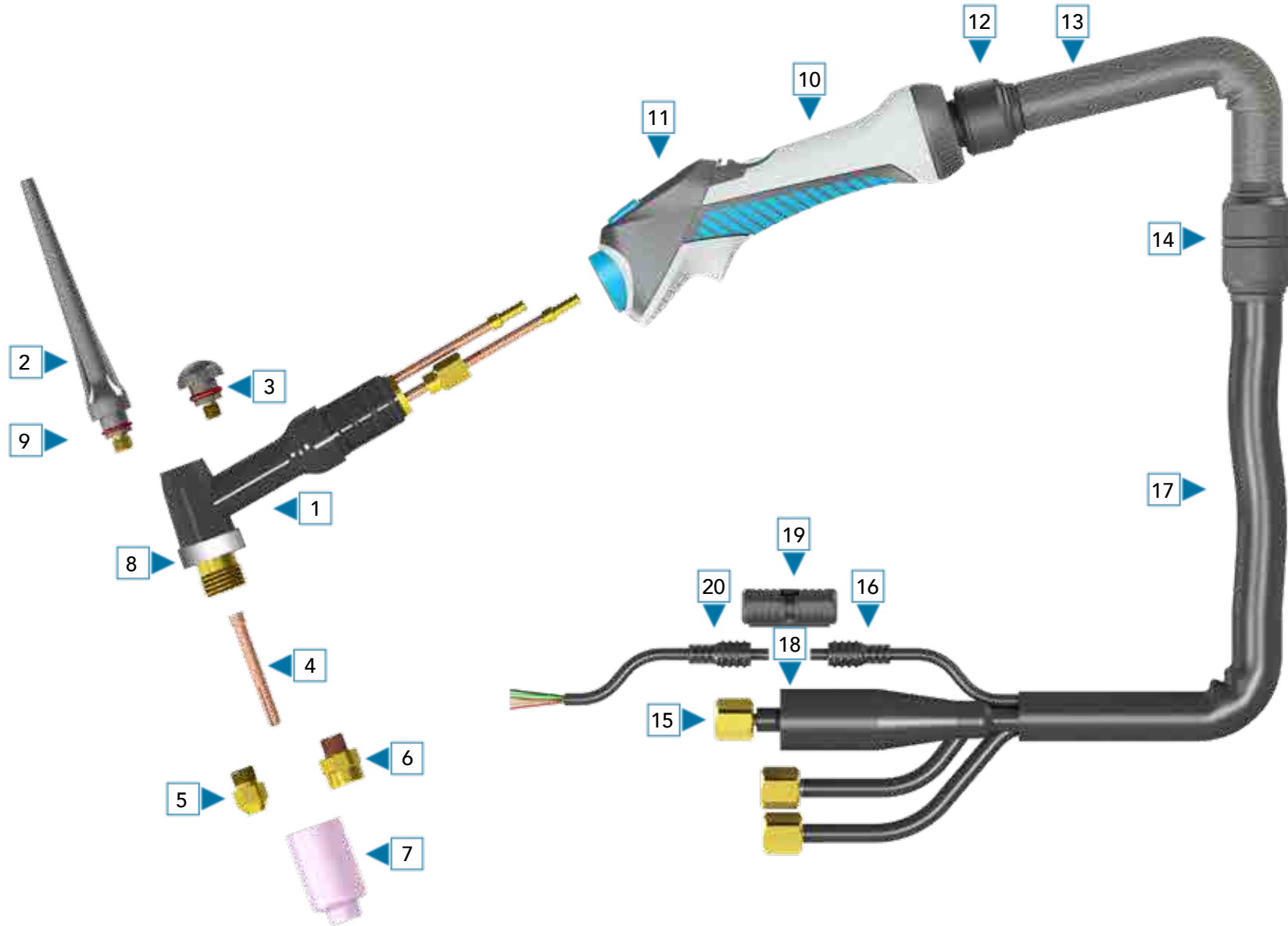

ITEM	PART NO.	DESCRIPTION	PACK QTY
COMPLETE TORCHES			
-	8X35014004600	8XT-18SC Tig torch 4mtr M12x1	1
-	8X35014004800	8XT-18SC Tig torch 4mtr 3/8'G	1
-	8X35014004650	8XT-18SC Tig torch 4mtr 35-50mm ²	1
-	8X35014008600	8XT-18SC Tig torch 8mtr M12x1	1
-	8X35014008800	8XT-18SC Tig torch 8mtr 3/8'G	1
-	8X35014008650	8XT-18SC Tig torch 8mtr 35-50mm ²	1
Other connections available on request			

ITEM	PART NO.	DESCRIPTION	PACK QTY
SPARE PARTS			
13	453756	Leather sheating 27mm L=50c	1
14	501298	Connection set (5-parts) for neoprene/leather 27mm	2
15	S30000400	Power/water cable 4mtr M12x1	1
	S30000422	Power/water cable 4mtr 3/8'G	1
	S30000800	Power/water cable 8mtr M12x1	1
	S30000822	Power/water cable 8mtr 3/8'G	1
16	306550	Switch cable 4mtr (QuickConnect)	1
	306552	Switch cable 8mtr (QuickConnect)	1
17	453780	Neoprene sheating 25mm p/mtr	10
18	500890	Insulation boot	2
19	306545	Locking clip (QuickConnect)	1
20	306559	Switch cable end without plug (QuickConnect)	1
Other Switch cable end with plugs Page 48			

ITEM	PART NO.	DESCRIPTION	PACK QTY
SPARE PARTS			
1	520350	Torch body super cooled	1
2	500346	57Y02 Back cap long	5
3	500348	57Y04 Back cap short	5
4	500670	10N24 Collet 2,4mm	5
Other collets see Page 40			
5	500802	NCB-53 Collet body 0,5 - 3,2mm	5
	500804	NCB-36 Collet body 2,4 - 4,0mm (Only with HD collet)	5
Other collets body see Page 42			
6	500815	18GL32 Gas lens 2,4mm	5
Other Gas lens see Page 43			
7	500584	54N16 Ceramic gas lens cup 9,5mm Gr. 6	10
Other Ceramic gas lens see Page 45			
8	500414	18NG Heat shield	5
9	500364	98W18 O-ring	25
10	8X9950	8XT Handle complete with 1-button switch	1
11	8X9510	8XT Switch module 1-button complete	1
Other Switch module see Page 46			
12	509210	Ball-and-socket joint with connection ring	2



HIGH-RELIABILITY



8XT - 20 TIG TORCH

DC - 220 AMP, AC/DC - 165 AMP, DUTY CYCLE - 100%

WATER COOLED

HIGH-QUALITY

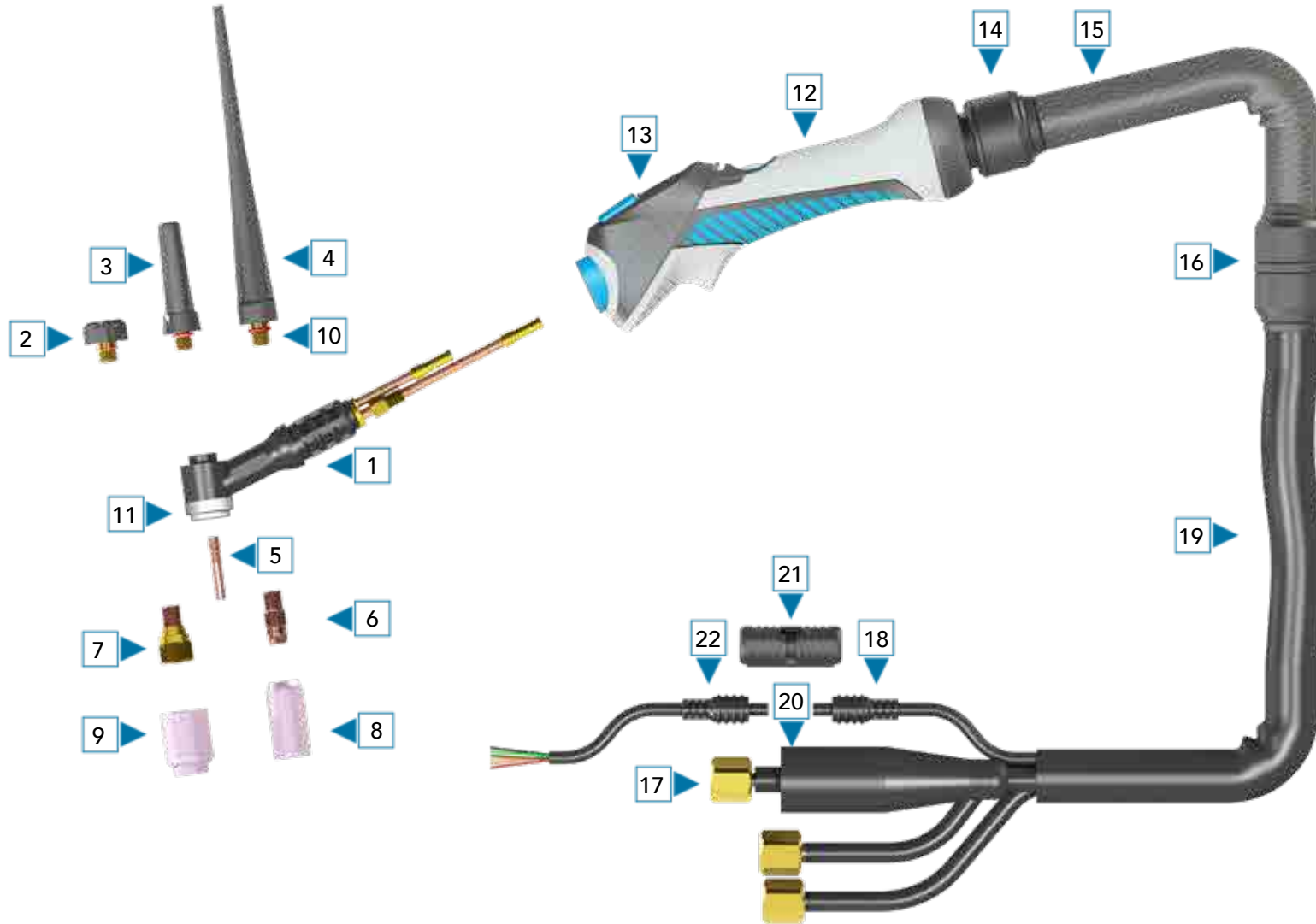

ITEM	PART NO.	DESCRIPTION	PACK QTY
COMPLETE TORCHES			
-	8X40014004600	8XT-20 Tig torch 4mtr M12x1	1
-	8X40014004800	8XT-20 Tig torch 4mtr 3/8'G	1
-	8X40014004650	8XT-20 Tig torch 4mtr 35-50mm ²	1
-	8X40014008600	8XT-20 Tig torch 8mtr M12x1	1
-	8X40014008800	8XT-20 Tig torch 8mtr 3/8'G	1
-	8X40014008650	8XT-20 Tig torch 8mtr 35-50mm ²	1
Other connections available on request			

ITEM	PART NO.	DESCRIPTION	PACK QTY
SPARE PARTS			
1	520400	Torch body standard	1
	520405	Torch body flexible	1
2	500342	41V33 Back cap short	5
3	500344	41V35 Back cap medium	5
4	500340	41V24 Back cap long	5
5	500658	13N23 Collet 2,4mm	5
Other collets see Page 40			
6	500758	13N28 Collet body 2,4mm	5
Other collets body see Page 42			
7	500828	45V44 Gas lens 2,4mm	5
Other Gas lens see Page 43			
8	500504	13N10 Ceramic cup 9,5mm Gr. 6	10
Other Ceramic cup see Page 44			
9	500564	53N60 Ceramic gas lens cup 9,5mm Gr. 6	10
Other Ceramic gas lens cup see Page 45			
10	500360	98W77 O-ring	25
11	500400	598882 Heat shield	5
12	8X9900	8XT Handle complete with 1-button switch	1
13	8X9510	8XT Switch module 1-button complete	1
Other Switch module see Page 46			



ITEM	PART NO.	DESCRIPTION	PACK QTY
SPARE PARTS			
14	509200	Ball-and-socket joint with connection ring	2
15	453752	Leather sheating 23mm L=50cm	1
16	501293	Connection set (5-parts) for neoprene/leather 23mm	2
17	S40000400	Power/water cable 4mtr M12x1	1
	S40000422	Power/water cable 4mtr 3/8'G	1
	S40000800	Power/water cable 8mtr M12x1	1
	S40000822	Power/water cable 8mtr 3/8'G	1
18	306550	Switch cable 4mtr (QuickConnect)	1
	306552	Switch cable 8mtr (QuickConnect)	1
19	453785	Neoprene sheating 23mm p/mtr	10
20	500890	Insulation boot	2
21	306545	Locking clip (QuickConnect)	1
22	306559	Switch cable end without plug (QuickConnect)	1
Other Switch cable end with plugs Page 48			

HIGH-RELIABILITY



8XT - 24 TIG TORCH

DC - 80 AMP, AC/DC - 60 AMP, DUTY CYCLE - 35%



AIR COOLED

HIGH AVAILABILITY

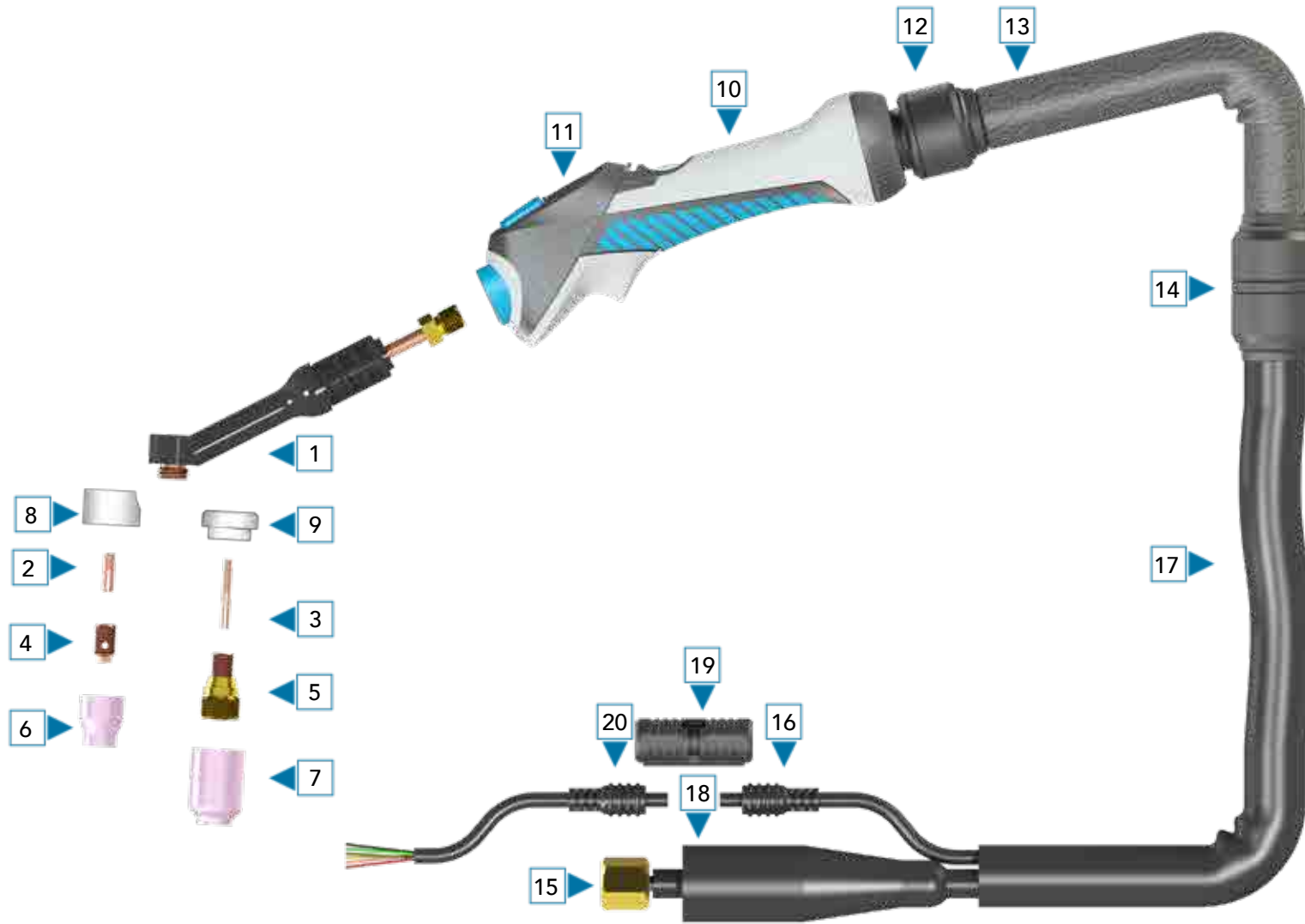

ITEM	PART NO.	DESCRIPTION	PACK QTY
COMPLETE TORCHES			
-	8X50010004000	8XT-24 Tig torch 4mtr M12x1	1
-	8X50010004220	8XT-24 Tig torch 4mtr 3/8'G	1
-	8X50013504400	8XT-24 Tig torch 4mtr 10-25mm ² (2PC)	1
-	8X50010008000	8XT-24 Tig torch 8mtr M12x1	1
-	8X50010008220	8XT-24 Tig torch 8mtr 3/8'G	1
-	8X50013508400	8XT-24 Tig torch 8mtr 10-25mm ² (2PC)	1
Other connections available on request			

ITEM	PART NO.	DESCRIPTION	PACK QTY
SPARE PARTS			
1	520500	Torch body standard	1
2	500684	53N14 Collet 1,6mm	5
3	500704	53N64 Collet for gas lens 1,6mm	5
Other collets see Page 40			
4	500782	53N19 Collet body 1,6mm	5
Other collets body see Page 42			
5	500824	45V43 Gas lens 1,6mm	5
Other Gas lens see Page 43			
6	500538	53N25 Ceramic cup 9,5mm Gr. 5	10
Other Ceramic cup see Page 44			
7	500562	53N59 Ceramic gas lens cup 9,5mm Gr. 5	10
Other Ceramic gas lens cup see Page 45			
8	500406	53N22 Heat shield for collet body	5
9	500410	53N66 Heat shield	5
10	8X9900	8XT Handle complete with 1-button switch	1
11	8X9510	8XT Switch module 1-button complete	1
Other Switch module see Page 46			



ITEM	PART NO.	DESCRIPTION	PACK QTY
SPARE PARTS			
12	509200	Ball-and-socket joint with connection ring	2
13	453752	Leather sheating 22mm L=50cm	1
14	501293	Connection set (5-parts) for neoprene/leather 23mm	2
15	S50000400	Power/gas cable 4mtr M12x1	1
	S50000422	Power/gas cable 4mtr 3/8'G	1
	S50000800	Power/gas cable 8mtr M12x1	1
	S50000822	Power/gas cable 8mtr 3/8'G	1
16	306550	Switch cable 4mtr (QuickConnect)	1
	306552	Switch cable 8mtr (QuickConnect)	1
17	453785	Neoprene sheating 23mm p/mtr	10
18	500890	Insulation boot	2
19	306545	Locking clip (QuickConnect)	1
20	306559	Switch cable end without plug (QuickConnect)	1
Other Switch cable end with plugs Page 48			

HIGH-RELIABILITY



8XT - 24W TIG TORCH

DC - 210 AMP, AC/DC - 165 AMP, DUTY CYCLE - 100%



WATER COOLED

HIGH-QUALITY

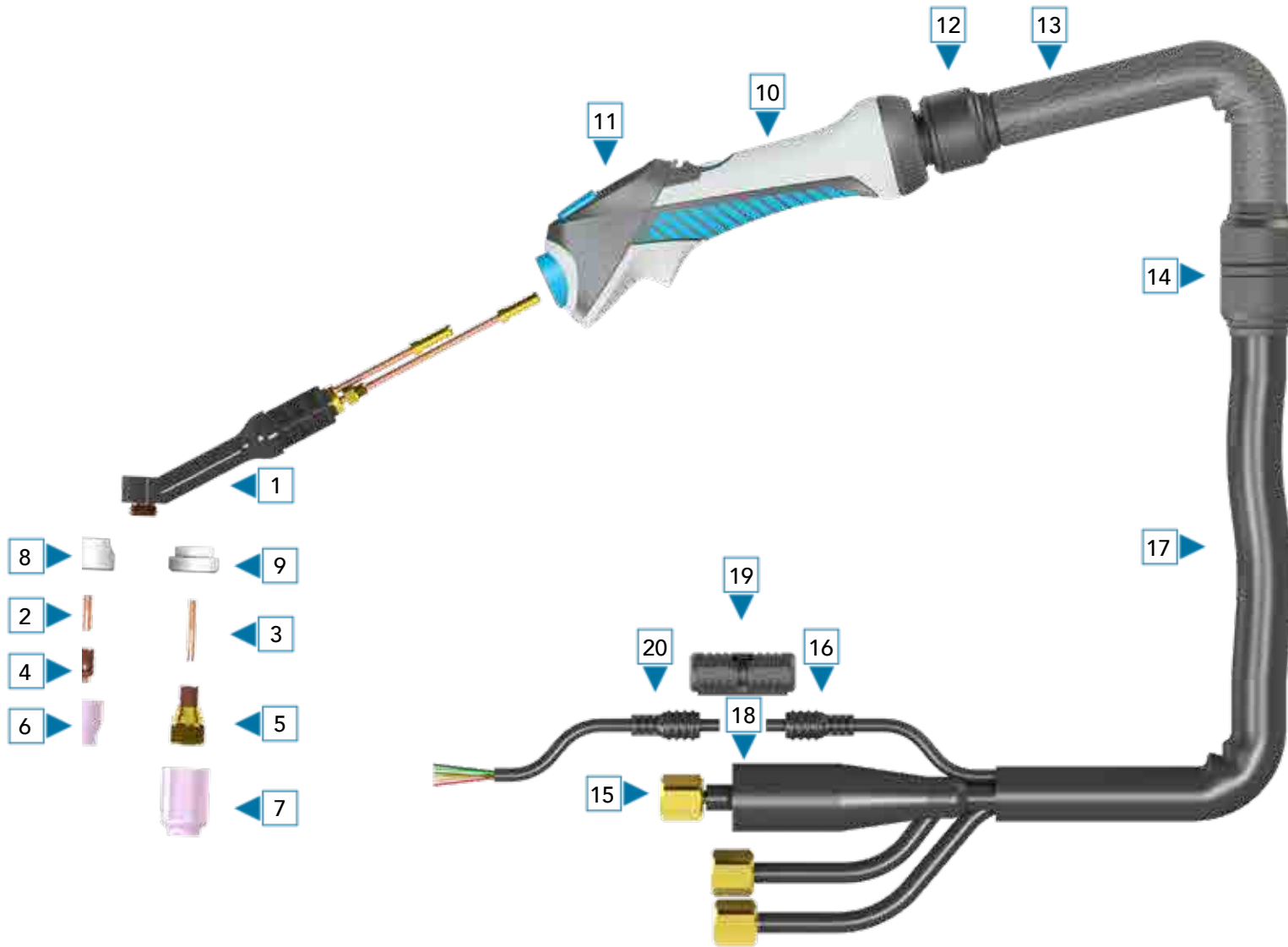

ITEM	PART NO.	DESCRIPTION	PACK QTY
COMPLETE TORCHES			
-	8X53014004600	8XT-24W Tig torch 4mtr M12x1	1
-	8X53014004800	8XT-24W Tig torch 4mtr 3/8'G	1
-	8X53014004650	8XT-24W Tig torch 4mtr 35-50mm ²	1
-	8X53014008600	8XT-24W Tig torch 8mtr M12x1	1
-	8X53014008800	8XT-24W Tig torch 8mtr 3/8'G	1
-	8X53014008650	8XT-24W Tig torch 8mtr 35-50mm ²	1
Other connections available on request			

ITEM	PART NO.	DESCRIPTION	PACK QTY
SPARE PARTS			
1	520505	Torch body standard	1
2	500684	53N14 Collet 1,6mm	5
3	500704	53N64 Collet for gas lens 1,6mm	5
Other collets see Page 40			
4	500782	53N19 Collet body 1,6mm	5
Other collets body see Page 42			
5	500824	45V43 Gas lens 1,6mm	5
Other Gas lens see Page 43			
6	500538	53N25 Ceramic cup 9,5mm Gr. 5	10
Other Ceramic cup see Page 44			
7	500562	53N59 Ceramic gas lens cup 9,5mm Gr. 5	10
Other Ceramic gas lens cup see Page 45			
8	500406	53N22 Heat shield for collet body	5
9	500410	53N66 Heat shield	5
10	8X9900	8XT Handle complete with 1-button switch	1
11	8X9510	8XT Switch module 1-button complete	1
Other Switch module see Page 46			



ITEM	PART NO.	DESCRIPTION	PACK QTY
SPARE PARTS			
12	509200	Ball-and-socket joint with connection ring	2
13	453752	Leather sheating 22mm L=50cm	1
14	501293	Connection set (5-parts) for neoprene/leather 23mm	2
15	S40000400	Power/water cable 4mtr M12x1	1
	S40000422	Power/water cable 4mtr 3/8'G	1
	S40000800	Power/water cable 8mtr M12x1	1
	S40000822	Power/water cable 8mtr 3/8'G	1
16	306550	Switch cable 4mtr (QuickConnect)	1
	306552	Switch cable 8mtr (QuickConnect)	1
17	453785	Neoprene sheating 23mm p/mtr	10
18	500890	Insulation boot	2
19	306545	Locking clip (QuickConnect)	1
20	306559	Switch cable end without plug (QuickConnect)	1
Other Switch cable end with plugs Page 48			

HIGH-RELIABILITY



8XT - 25F TIG TORCH

DC - 180 AMP, AC/DC - 80 AMP, DUTY CYCLE - 35%



WATER COOLED

HIGH-QUALITY

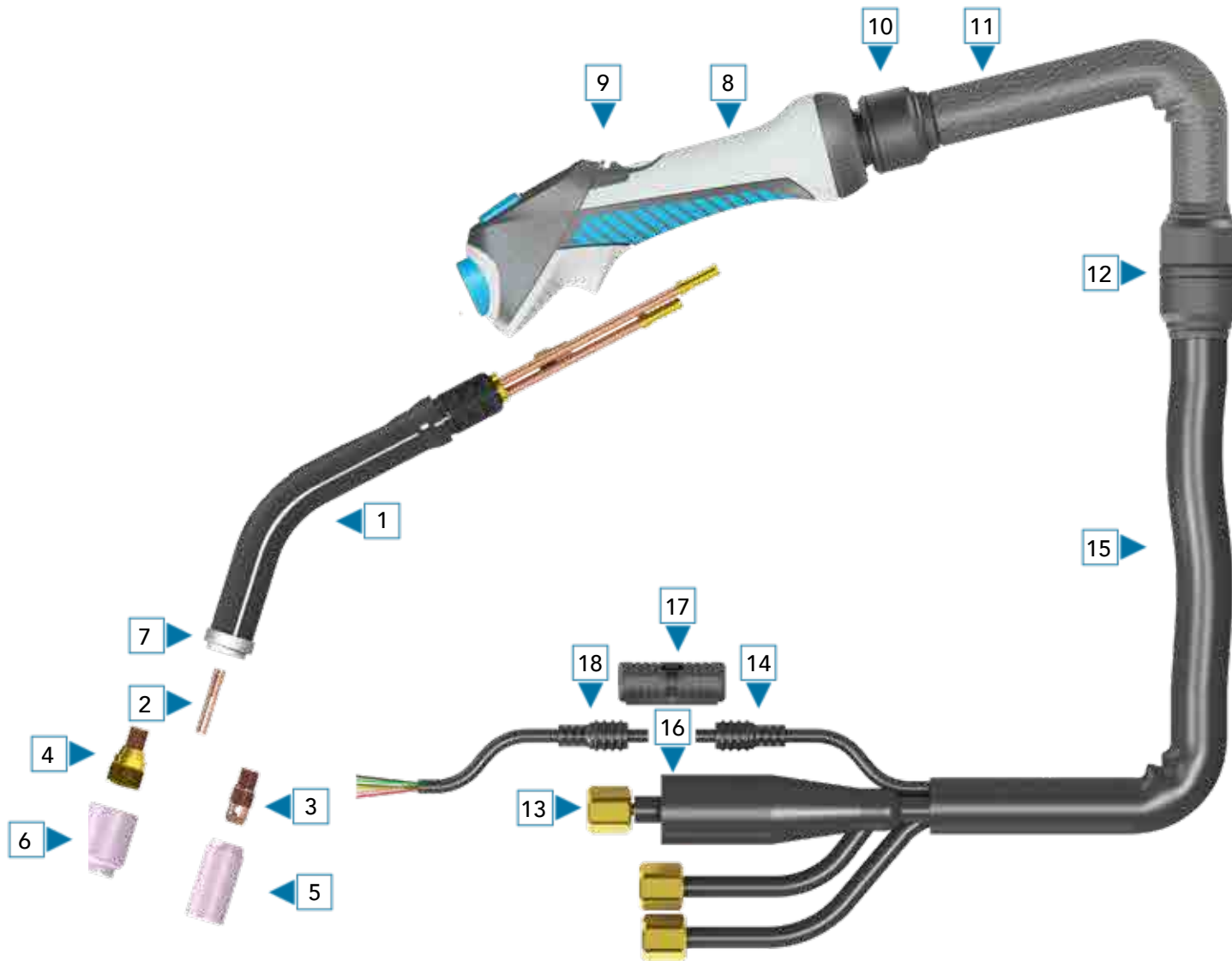

ITEM	PART NO.	DESCRIPTION	PACK QTY
COMPLETE TORCHES			
-	8X58014004600	8XT-25F Tig torch 4mtr M12x1	1
-	8X58014004800	8XT-25F Tig torch 4mtr 3/8'G	1
-	8X58014004650	8XT-25F Tig torch 4mtr 35-50mm ²	1
-	8X58014008600	8XT-25F Tig torch 8mtr M12x1	1
-	8X58014008800	8XT-25F Tig torch 8mtr 3/8'G	1
-	8X58014008650	8XT-25F Tig torch 8mtr 35-50mm ²	1
Other connections available on request			

ITEM	PART NO.	DESCRIPTION	PACK QTY
SPARE PARTS			
1	520550	Torch body flexible	1
2	500658	13N23 Collet 2,4mm	5
Other collets see Page 40			
3	500758	13N28 Collet body 2,4mm	5
Other collets body see Page 42			
4	500828	45V44 Gas lens 2,4mm	5
Other Gas lens see Page 43			
5	500504	13N10 Ceramic cup 9,5mm Gr. 6	10
Other Ceramic cup see Page 44			
6	500564	53N60 Ceramic gas lens cup 9,5mm Gr. 6	10
Other Ceramic gas lens cup see Page 45			
7	500400	598882 Heat shield	5
8	8X9900	8XT Handle complete with 1-button switch	1
9	8X9510	8XT Switch module 1-button complete	1
Other Switch module see Page 46			

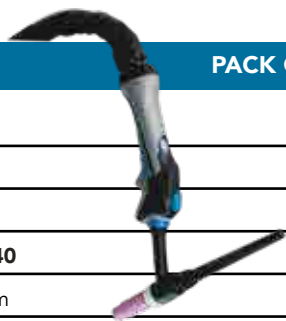

ITEM	PART NO.	DESCRIPTION	PACK QTY
SPARE PARTS			
10	509200	Ball-and-socket joint with connection ring	2
11	453752	Leather sheating 22mm L=50cm	1
12	501293	Connection set (5-parts) for neoprene/leather 23mm	2
13	S40000400	Power/water cable 4mtr M12x1	1
	S40000422	Power/water cable 4mtr 3/8'G	1
	S40000800	Power/water cable 8mtr M12x1	1
	S40000822	Power/water cable 8mtr 3/8'G	1
14	306550	Switch cable 4mtr (QuickConnect)	1
	306552	Switch cable 8mtr (QuickConnect)	1
15	453785	Neoprene sheating 23mm p/mtr	10
16	500890	Insulation boot	2
17	306545	Locking clip (QuickConnect)	1
18	306559	Switch cable end without plug (QuickConnect)	1
Other Switch cable end with plugs Page 48			

HIGH-RELIABILITY



8XT - 26 TIG TORCH

DC - 180 AMP, AC/DC - 130 AMP, DUTY CYCLE - 35%

AIR COOLED

HIGH-QUALITY

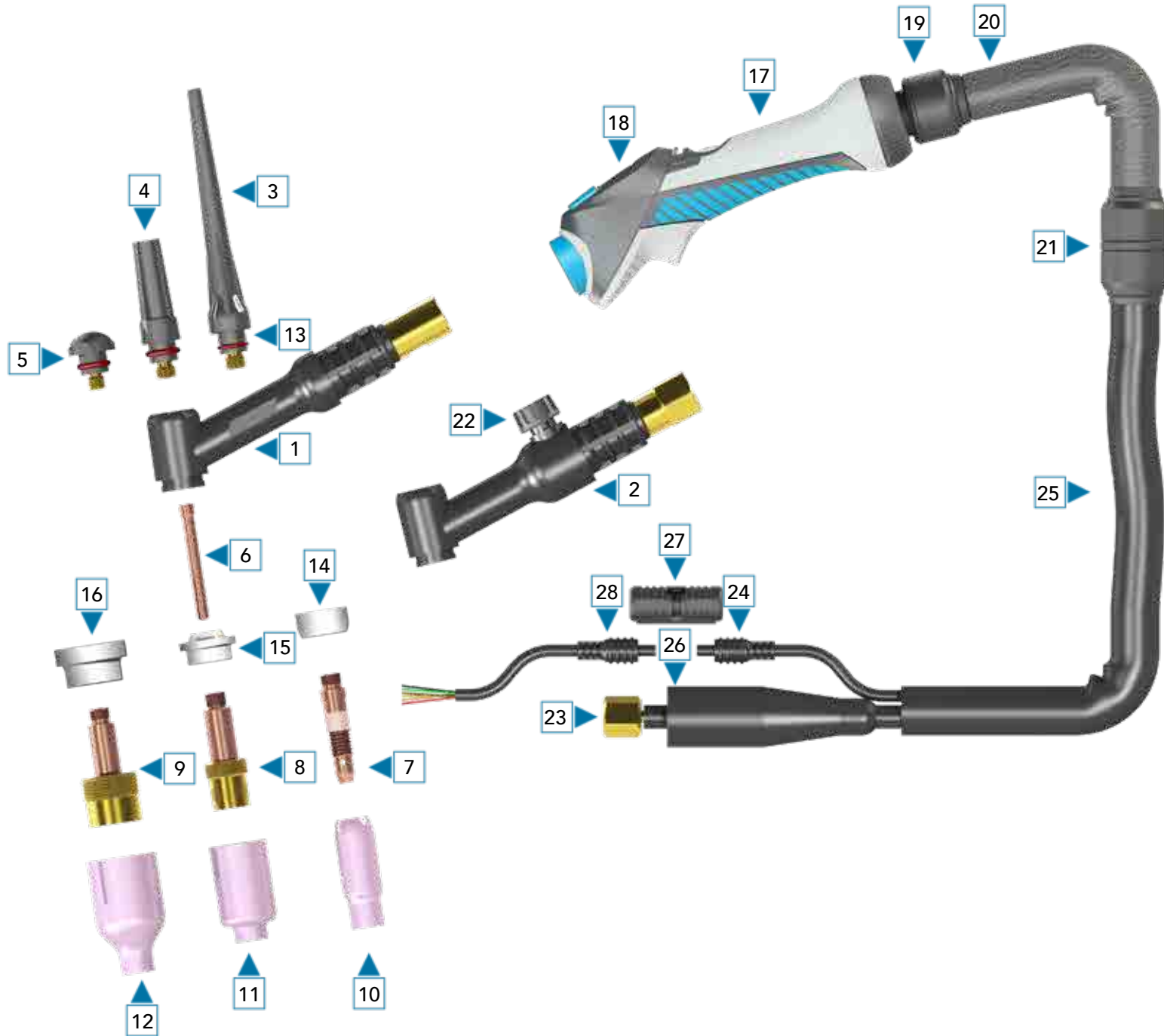

ITEM	PART NO.	DESCRIPTION	PACK QTY
COMPLETE TORCHES			
-	8X70010004000	8XT-26 Tig torch 4mtr M12x1	1
-	8X70010004210	8XT-26 Tig torch 4mtr 1/4'G	1
-	8X70010004220	8XT-26 Tig torch 4mtr 3/8'G	1
-	8X70013504500	8XT-26 Tig torch 4mtr 35-50mm ² (2PC)	1
-	8X7100360450X	8XT-26V Tig torch 4mtr 35-50mm ² (2PC)	1
-	8X70010008000	8XT-26 Tig torch 8mtr M12x1	1
-	8X70010008210	8XT-26 Tig torch 8mtr 1/4'G	1
-	8X70010008220	8XT-26 Tig torch 8mtr 3/8'G	1
-	8X70013508500	8XT-26 Tig torch 8mtr 35-50mm ² (2PC)	1
-	8X7100360850X	8XT-26V Tig torch 8mtr 35-50mm ² (2PC)	1
Other connections available on request			

ITEM	PART NO.	DESCRIPTION	PACK QTY
SPARE PARTS			
1	520600	Torch body standard	1
	520605	Torch body flexible	1
2	520610	Torch body valve	1
	520615	Torch body flexible /valve	1
3	500346	57Y02 Back cap long	5
4	500347	300M Back cap medium	5
5	500348	57Y04 Back cap short	5
6	500670	10N24 Collet 2,4mm	5
Other collets see Page 40			
7	500770	10N32 Collet body 2,4mm	5
Other collets body see Page 42			



ITEM	PART NO.	DESCRIPTION	PACK QTY
SPARE PARTS			
8	500836	45V26 Gas lens 2,4mm	5
9	500850	45V64 large gas lens 2,4mm	2
Other Gas lens see Page 43			
10	500524	10N48 Ceramic cup 9,5mm Gr. 6	10
Other Ceramic cup see Page 44			
11	500584	54N16 Ceramic gas lens cup 9,5mm Gr. 6	10
12	500638	57N75 Ceramic large Gas lens cup 9,5mm Gr. 6	5
Other Ceramic gas lens cup see Page 45			
13	500364	98W18 O-ring	25
14	500402	18CG Heat shield for collet body	5
15	500404	54N01 Heat shield for gas lens	5
16	500412	54N63 Heat shield for larage gas lens	5
17	8X9950	8XT Handle complete with 1-button switch	1
18	8X9510	8XT Switch module 1-button complete	1
Other Switch module see Page 46			
19	509210	Ball-and-socket joint with connection ring	2
20	453756	Leather sheating 27mm L=50cm	1
21	501298	Connection set (5-parts) for neoprene/leather 27mm	2
22	500372	VS26 Valve	2
23	S70000400	Power/gas cable 4mtr M12x1	1
	S70000421	Power/gas cable 4mtr 1/4'G	1
	S70000422	Power/gas cable 4mtr 3/8'G	1
	S70000800	Power/gas cable 8mtr M12x1	1
	S70000821	Power/gas cable 8mtr 1/4'G	1
	S70000822	Power/gas cable 8mtr 3/8'G	1
24	306550	Switch cable 4mtr (QuickConnect)	1
	306552	Switch cable 8mtr (QuickConnect)	1
25	453780	Neoprene sheating 25mm p/mtr	10
26	500890	Insulation boot	2
27	306545	Locking clip (QuickConnect)	1
28	306559	Switch cable end without plug (QuickConnect)	1
Other Switch cable end with plugs Page 48			

HIGH-RELIABILITY



8XT - 28 TIG TORCH

DC - 300 AMP, AC/DC - 250 AMP, DUTY CYCLE - 35%

TIG
TORCHES

AIR COOLED

HIGH-QUALITY

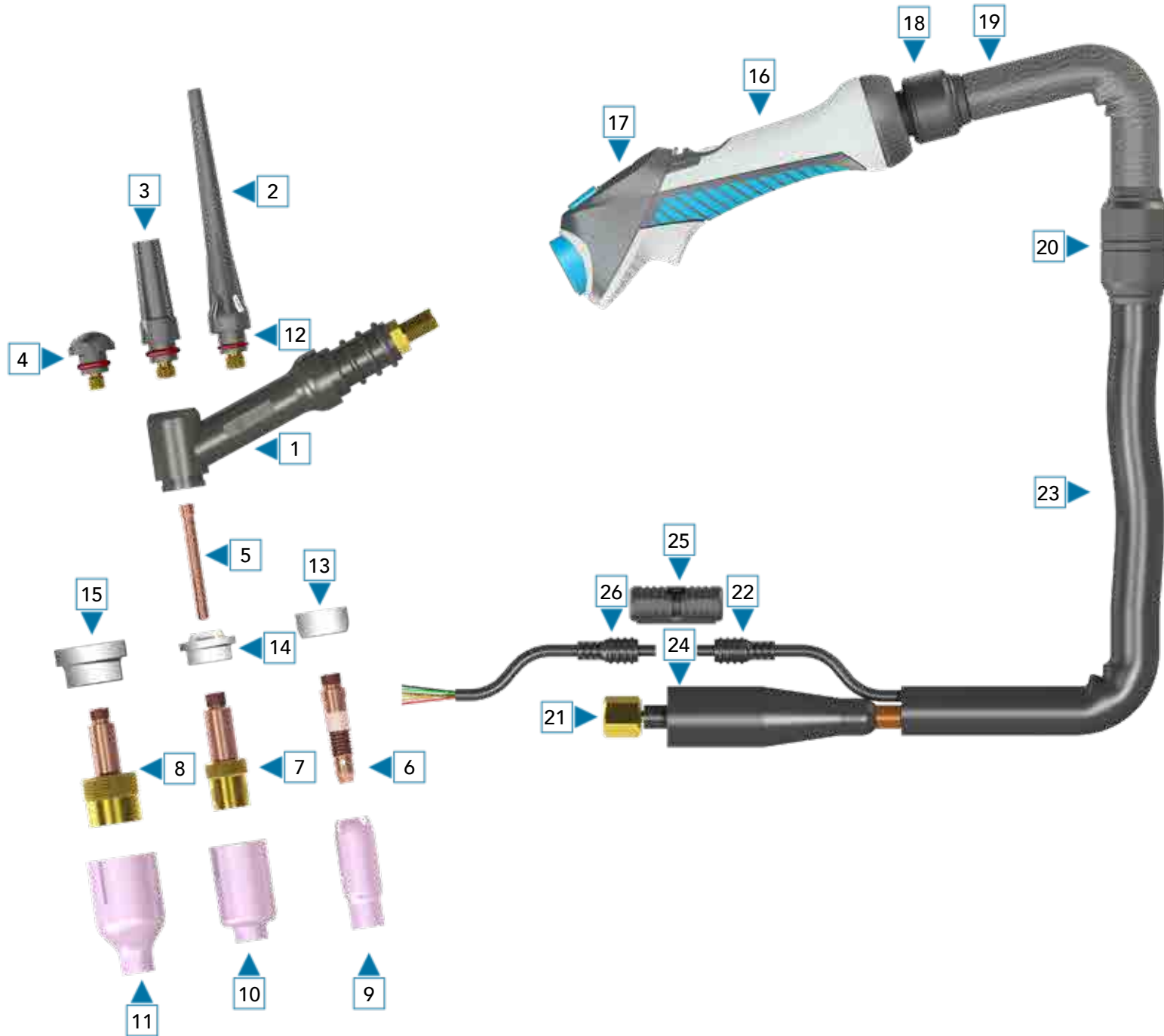

ITEM	PART NO.	DESCRIPTION	PACK QTY
COMPLETE TORCHES			
-	8X75013504500	8XT-28 Tig torch 4mtr 35-50mm ² (2PC)	1
-	8X75013508500	8XT-28 Tig torch 8mtr 35-50mm ² (2PC)	1

ITEM	PART NO.	DESCRIPTION	PACK QTY
SPARE PARTS			
1	500260	Torch body standard	1
2	500346	57Y02 Back cap long	5
3	500347	300M Back cap medium	5
4	500348	57Y04 Back cap short	5
5	500670	10N24 Collet 2,4mm	5
Other collets see Page 40			
6	500770	10N32 Collet body 2,4mm	5
Other collets body see Page 42			

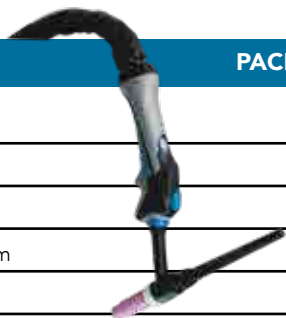

ITEM	PART NO.	DESCRIPTION	PACK QTY
SPARE PARTS			
7	500836	45V26 Gas lens 2,4mm	5
8	500850	45V64 large gas lens 2,4mm	2
Other Gas lens see Page 43			
9	500524	10N48 Ceramic cup 9,5mm Gr. 6	10
Other Ceramic cup see Page 44			
10	500584	54N16 Ceramic gas lens cup 9,5mm Gr. 6	10
11	500638	57N75 Ceramic large gas lens cup 9,5mm Gr. 6	5
Other Ceramic gas lens cup see Page 45			
12	500364	98W18 O-ring	25
13	500402	18CG Heat shield for collet body	5
14	500404	54N01 Heat shield for gas lens	5
15	500412	54N63 Heat shield for larage gas lens	5
16	8X9950	8XT Handle complete with 1-button switch	1
17	8X9510	8XT Switch module 1-button complete	1
Other Switch module see Page 46			
18	509210	Ball-and-socket joint with connection ring	2
19	453756	Leather sheating 27mm L=50cm	1
20	501298	Connection set (5-parts) for neoprene/leather 27mm	2
21	5002604	Power cable 4mtr	1
	5002608	Power cable 8mtr	1
22	306550	Switch cable 4mtr (QuickConnect)	1
	306552	Switch cable 8mtr (QuickConnect)	1
23	453780	Neoprene sheating 25mm p/mtr	10
24	500890	Insulation boot	2
25	306545	Locking clip (QuickConnect)	1
26	306559	Switch cable end without plug (QuickConnect)	1
Other Switch cable end with plugs Page 48			

HIGH-RELIABILITY



8XT - 30 TIG TORCH

DC - 320 AMP, AC/DC - 230 AMP, DUTY CYCLE - 100%



WATER COOLED

HIGH-QUALITY

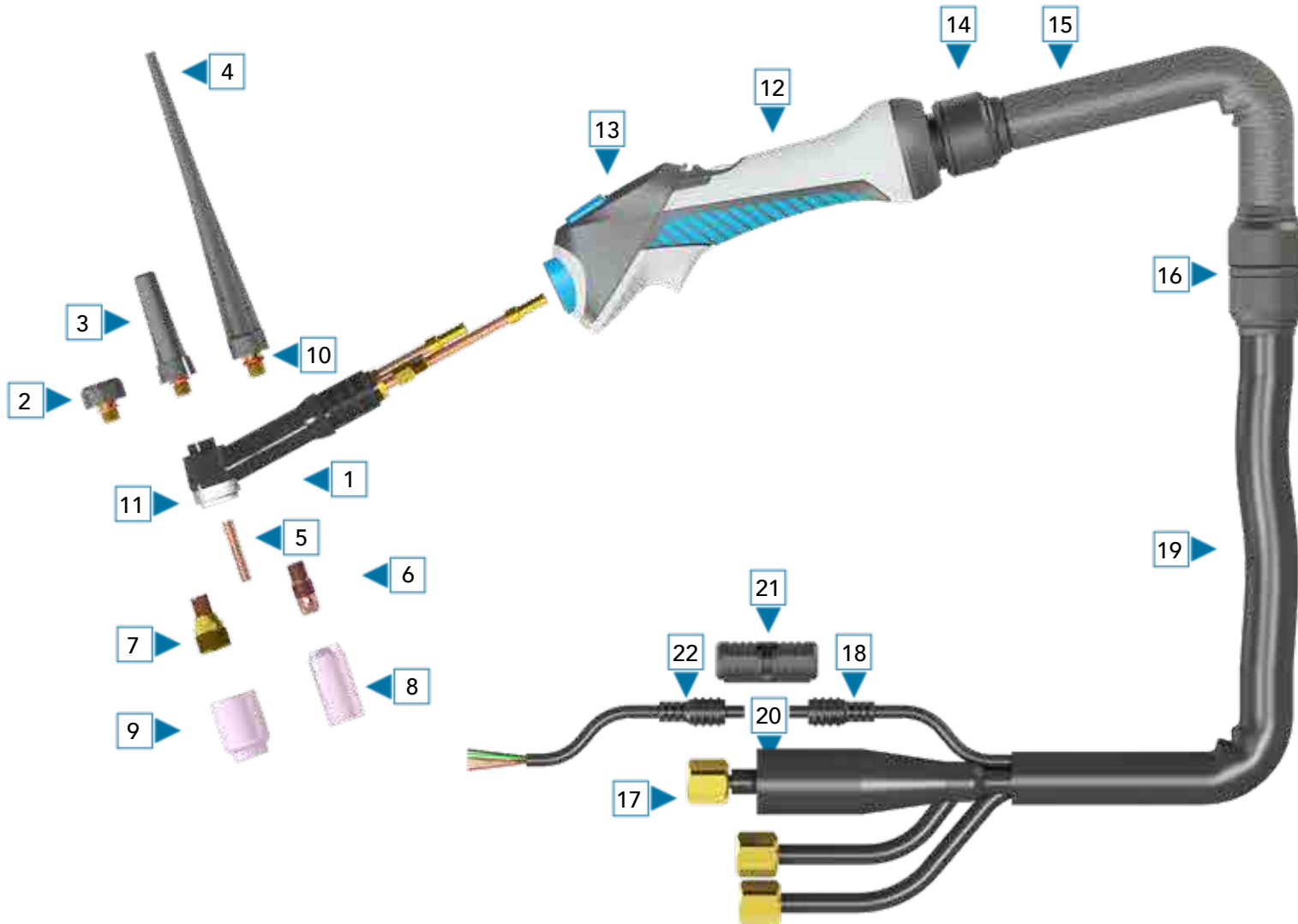

ITEM	PART NO.	DESCRIPTION	PACK QTY
COMPLETE TORCHES			
-	8X60014004600	8XT-30 Tig torch 4mtr M12x1	1
-	8X60014004800	8XT-30 Tig torch 4mtr 3/8'G	1
-	8X60014004650	8XT-30 Tig torch 4mtr 35-50mm ²	1
-	8X60014008600	8XT-30 Tig torch 8mtr M12x1	1
-	8X60014008800	8XT-30 Tig torch 8mtr 3/8'G	1
-	8X60014008650	8XT-30 Tig torch 8mtr 35-50mm ²	1
Other connections available on request			

ITEM	PART NO.	DESCRIPTION	PACK QTY
SPARE PARTS			
1	520700	Torch body standard	1
2	500342	41V33 Back cap short	5
3	500344	41V35 Back cap medium	5
4	500340	41V24 Back cap long	5
5	500658	13N23 Collet 2,4mm	5
Other collets see Page 40			
6	500758	13N28 Collet body 2,4mm	5
Other collets body see Page 42			
7	500828	45V44 Gas lens 2,4mm	5
Other Gas lens see Page 43			
8	500504	13N10 Ceramic cup 9,5mm Gr. 6	10
Other Ceramic cup see Page 44			
9	500564	53N60 Ceramic gas lens cup 9,5mm Gr. 6	10
Other Ceramic gas lens cup see Page 45			
10	500360	98W77 O-ring	25
11	500400	598882 Heat shield	5
12	8X9900	8XT Handle complete with 1-button switch	1
13	8X9510	8XT Switch module 1-button complete	1
Other Switch module see Page 46			



ITEM	PART NO.	DESCRIPTION	PACK QTY
SPARE PARTS			
14	509200	Ball-and-socket joint with connection ring	2
15	453752	Leather sheathing 22mm L=50cm	1
16	501293	Connection set (5-parts) for neoprene/leather 23mm	2
17	S60400400	Power/water cable 4mtr M12x1	1
	S60400422	Power/water cable 4mtr 3/8'G	1
	S60400800	Power/water cable 8mtr M12x1	1
	S60400822	Power/water cable 8mtr 3/8'G	1
18	306550	Switch cable 4mtr (QuickConnect)	1
	306552	Switch cable 8mtr (QuickConnect)	1
19	453785	Neoprene sheathing 23 mm p/mtr	10
20	500890	Insulation boot	2
21	306545	Locking clip (QuickConnect)	1
22	306559	Switch cable end without plug (QuickConnect)	1
Other Switch cable end with plugs Page 48			

HIGH-RELIABILITY



8XT - 121 TIG TORCH

DC - 160 AMP, AC/DC - 120 AMP, DUTY CYCLE - 35%

AIR COOLED

HIGH-QUALITY

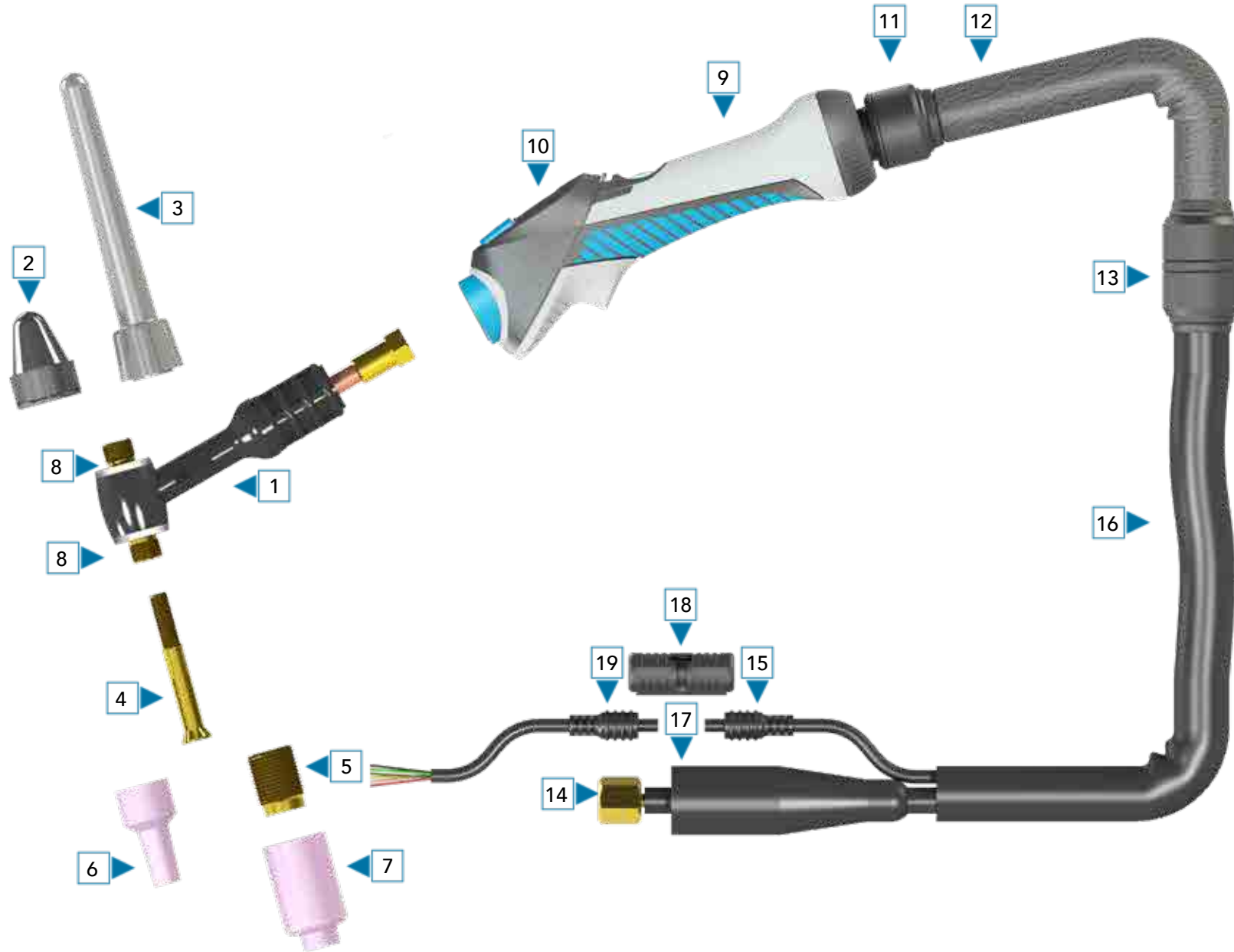

ITEM	PART NO.	DESCRIPTION	PACK QTY
COMPLETE TORCHES			
-	8X81010004000	8XT-121 Tig torch 4mtr M12x1	1
-	8X81010004220	8XT-121 Tig torch 4mtr 3/8'G	1
-	8X81013504500	8XT-121 Tig torch 4mtr 35-50mm ² (2PC)	1
-	8X81010008000	8XT-121 Tig torch 8mtr M12x1	1
-	8X81010008220	8XT-121 Tig torch 8mtr 3/8'G	1
-	8X81013508500	8XT-121 Tig torch 8mtr 35-50mm ² (2PC)	1
Other connections available on request			

ITEM	PART NO.	DESCRIPTION	PACK QTY
SPARE PARTS			
1	504125	Torch body standard	1
2	504230	0315041 Back cap short	5
3	504220	0315042 Back cap long	5
4	506004	0315022 Collet 2,4mm	5
Other collets see Page 40			
5	506074	0316026 Gas lens 2,4mm	2
Other Gas lens see Page 43			
6	506284	0315034 Ceramic cup short 9,5mm	10
Other Ceramic cup see Page 44			
7	500584	0315082 Ceramic gas lens cup 9,5mm Gr. 6	10
Other Ceramic cup see Page 45			
8	504310	0315049 Seal washer	5
9	8X9950	8XT Handle complete with 1-button switch	1
10	8X9510	8XT Switch module 1-button complete	1
Other Switch module see Page 46			



ITEM	PART NO.	DESCRIPTION	PACK QTY
SPARE PARTS			
11	509210	Ball-and-socket joint with connection ring	2
12	453756	Leather sheating 27mm L=50cm	1
13	501298	Connection set (5-parts) for neoprene/leather 27mm	2
14	S20000400	Power/gas cable 4mtr M12x1	1
	S20000422	Power/gas cable 4mtr 3/8'G	1
	S20000800	Power/gas cable 8mtr M12x1	1
	S20000822	Power/gas cable 8mtr 3/8'G	1
15	306550	Switch cable 4mtr (QuickConnect)	1
	306552	Switch cable 8mtr (QuickConnect)	1
16	453780	Neoprene sheating 25mm p/mtr	10
17	500890	Insulation boot	2
18	306545	Locking clip (QuickConnect)	1
19	306559	Switch cable end without plug (QuickConnect)	1
Other Switch cable end with plugs Page 48			

HIGH-RELIABILITY



8XT - 301 TIG TORCH

DC - 350 AMP, AC/DC - 250 AMP, DUTY CYCLE - 100%



WATER COOLED

HIGH-QUALITY

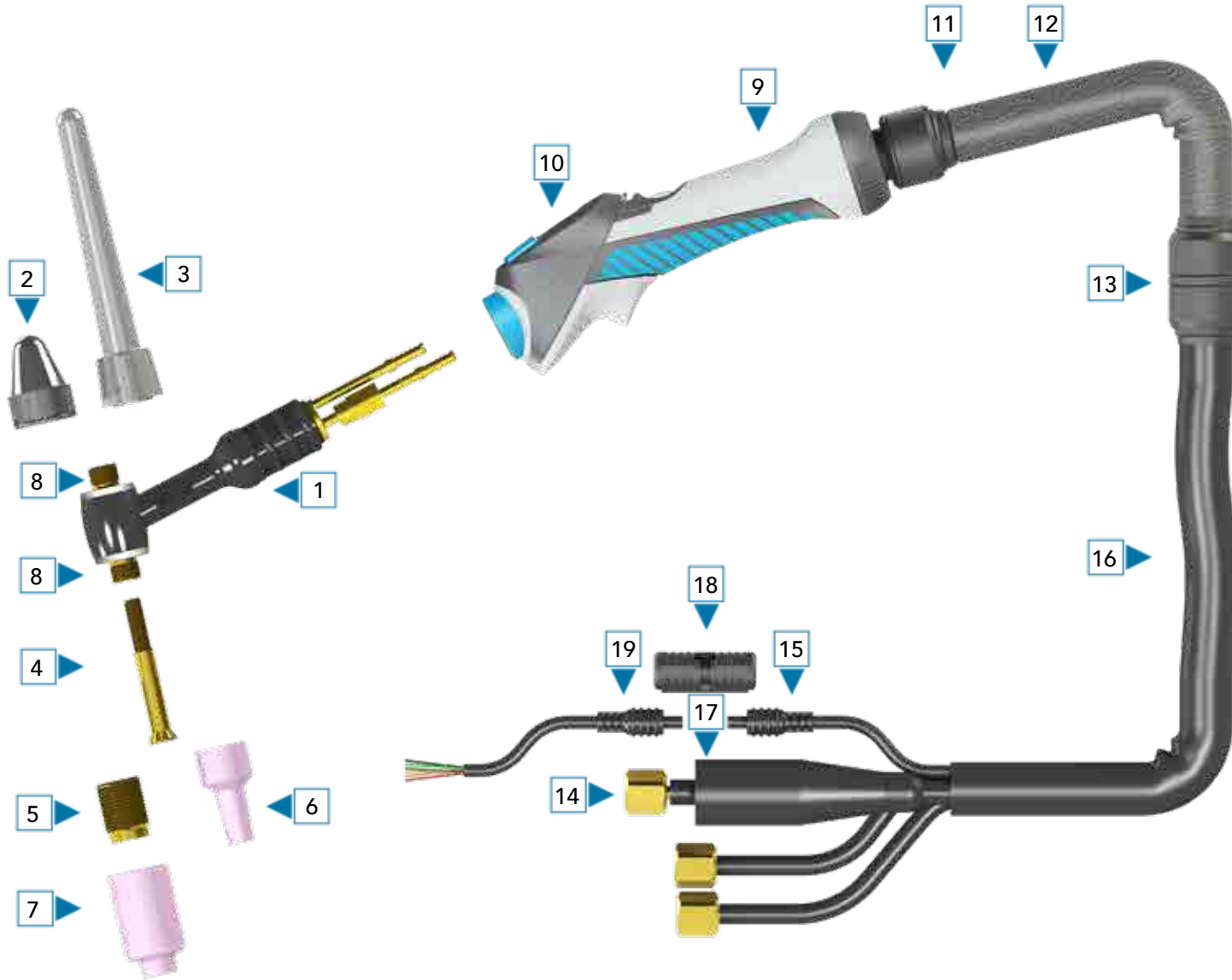

ITEM	PART NO.	DESCRIPTION	PACK QTY
COMPLETE TORCHES			
-	8X83014004600	8XT-301 Tig torch 4mtr M12x1	1
-	8X83014004800	8XT-301 Tig torch 4mtr 3/8'G	1
-	8X83014004650	8XT-301 Tig torch 4mtr 35-50mm ²	1
-	8X83014008600	8XT-301 Tig torch 8mtr M12x1	1
-	8X83014008800	8XT-301 Tig torch 8mtr 3/8'G	1
-	8X83014004650	8XT-301 Tig torch 8mtr 35-50mm ²	1
Other connections available on request			

ITEM	PART NO.	DESCRIPTION	PACK QTY
SPARE PARTS			
1	504115	Torch body standard	1
2	504230	0315041 Back cap short	5
3	504220	0315042 Back cap long	5
4	506004	0315022 Collet 2,4mm	5
Other collets see Page 40			
5	506074	0316026 Gas lens 2,4mm	2
Other Gas lens see Page 43			
6	506284	0315034 Ceramic cup short 9,5mm	10
7	500584	0315082 Gas lens cup 9,5mm Gr. 6	10
Other Ceramic cup see Page 44			
8	504310	0315049 Seal washer	5
9	8X9950	8XT Handle complete with 1-button switch	1
10	8X9510	8XT Switch module 1-button complete	1
Other Switch module see Page 46			



ITEM	PART NO.	DESCRIPTION	PACK QTY
SPARE PARTS			
11	509210	Ball-and-socket joint with connection ring	2
12	453756	Leather sheathing 27mm L=50cm	1
13	501298	Connection set (5-parts) for neoprene/leather 27mm	2
14	S30000400	Power/water cable 4mtr M12x1	1
	S30000422	Power/water cable 4mtr 3/8'G	1
	S30000800	Power/water cable 8mtr M12x1	1
	S30000822	Power/water cable 8mtr 3/8'G	1
15	306550	Switch cable 4mtr (QuickConnect)	1
	306552	Switch cable 8mtr (QuickConnect)	1
16	453780	Neoprene sheathing 25mm p/mtr	10
17	500890	Insulation boot	2
18	306545	Locking clip (QuickConnect)	1
19	306559	Switch cable end without plug (QuickConnect)	1
Other Switch cable end with plugs Page 48			

HIGH-RELIABILITY



8XT - 450 TIG TORCH

DC - 450 AMP, AC/DC - 360 AMP, DUTY CYCLE - 100%

WATER COOLED

HIGH-QUALITY

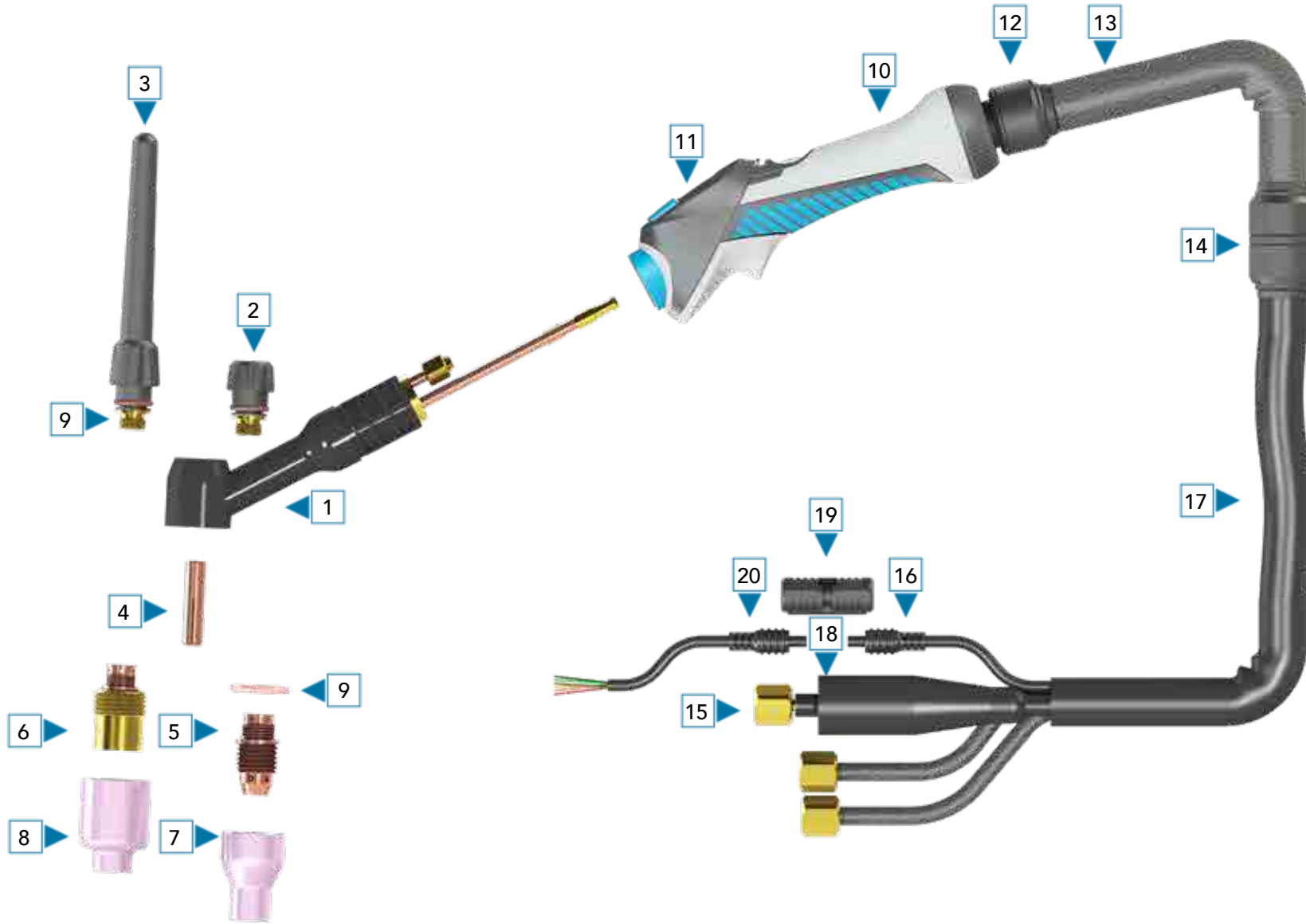

ITEM	PART NO.	DESCRIPTION	PACK QTY
COMPLETE TORCHES			
-	8X84014004600	8XT-450 Tig torch 4mtr M12x1	1
-	8X84014004800	8XT-450 Tig torch 4mtr 3/8'G	1
-	8X84014004650	8XT-450 Tig torch 4mtr 35-50mm ²	1
-	8X84014008600	8XT-450 Tig torch 8mtr M12x1	1
-	8X84014008800	8XT-450 Tig torch 8mtr 3/8'G	1
-	8X84014008650	8XT-450 Tig torch 8mtr 35-50mm ²	1
Other connections available on request			

ITEM	PART NO.	DESCRIPTION	PACK QTY
SPARE PARTS			
1	502051	Torch body	1
2	502072	0314004 Back cap short	5
3	502070	0314003 Back cap long	5
4	502554	0314102 Collet 2,4mm	5
Other collets see Page 40			
5	502560	0314200 Collet body (all sizes)	2
Other collets body see Page 42			
6	502700	0314300 Gas lens (all sizes)	2
Other Gas lens see Page 43			
7	502400	0314201 Ceramic cup 9,5mm	10
Other Ceramic cup see Page 44			
8	502450	0314301 Ceramic gas lens cup 9,5mm	10
Other Ceramic gas lens cup see Page 45			
9	502210	0314007 O-ring (set)	1
10	8X9950	8XT Handle complete with 1-button switch	1
11	8X9510	8XT Switch module 1-button complete	1
Other Switch module see Page 46			



ITEM	PART NO.	DESCRIPTION	PACK QTY
SPARE PARTS			
12	509210	Ball-and-socket joint with connection ring	2
13	453756	Leather sheating 27mm L=50cm	1
14	501298	Connection set (5-parts) for neoprene/leather 27mm	2
15	S88000400	Power/water cable 4mtr M12x1	1
	S88000422	Power/water cable 4mtr 3/8'G	1
	S88000800	Power/water cable 8mtr M12x1	1
	S88000822	Power/water cable 8mtr 3/8'G	1
16	306550	Switch cable 4mtr (QuickConnect)	1
	306552	Switch cable 8mtr (QuickConnect)	1
17	453780	Neoprene sheating 25mm p/mtr	10
18	500890	Insulation boot	2
19	306545	Locking clip (QuickConnect)	1
20	306559	Switch cable end without plug (QuickConnect)	1
Other Switch cable end with plugs Page 48			

HIGH-RELIABILITY



TIG WEAR PARTS

COLLETS



HIGH-QUALITY



PART NUMBER	DESCRIPTION	SIZE	PACK QTY
500652	13N21 COLLET 1.0MM 9/20/25F/30	25.5 mm	5
500654	13N22 COLLET 1.6MM 9/20/25F/30	25.5 mm	5
500656	70066 COLLET 2.0MM 9/20/25F/30	25.5 mm	5
500658	13N23 COLLET 2.4MM 9/20/25F/30	25.5 mm	5
500660	13N24 COLLET 3.2MM 9/20/25F/30	25.5 mm	5



PART NUMBER	DESCRIPTION	SIZE	PACK QTY
500664	10N22 COLLET 1.0MM 17/18/26	50 mm	5
500666	10N23 COLLET 1.6MM 17/18/26	50 mm	5
500668	70062 COLLET 2.0MM 17/18/26	50 mm	5
500670	10N24 COLLET 2.4MM 17/18/26	50 mm	5
500672	70063 COLLET 3.0MM 17/18/26	50 mm	5
500674	10N25 COLLET 3.2MM 17/18/26	50 mm	5
500676	54N20 COLLET 4.0MM 17/18/26	50 mm	5



PART NUMBER	DESCRIPTION	SIZE	PACK QTY
500724	10N23S COLLET STUBBY 1.6MM 17/18/26	29 mm	5
500726	10N24S COLLET STUBBY 2.4MM 17/18/26	29 mm	5
500728	10N25S COLLET STUBBY 3.2MM 17/18/26	29 mm	5



PART NUMBER	DESCRIPTION	SIZE	PACK QTY
5006705	10N24HD COLLET HD 2.4MM 18SC	50 mm	5
5006755	10N25HD COLLET HD 3.2MM 18SC	50 mm	5
5006765	54N20HD COLLET HD 4.0MM 18SC	50 mm	5



PART NUMBER	DESCRIPTION	SIZE	PACK QTY
500682	53N16 COLLET 1.0MM 24/24W	13.5 mm	5
500684	53N14 COLLET 1.6MM 24/24W	13.5 mm	5
500688	24C332 COLLET 2.4MM 24/24W	13.5 mm	5



TIG WEAR PARTS

COLLETS

TIG
TORCHES



PART NUMBER	DESCRIPTION	SIZE	PACK QTY
500702	53N63 COLLET FOR GAS LENS 1.0MM 24/24W	23 mm	5
500704	53N64 COLLET FOR GAS LENS 1.6MM 24/24W	23 mm	5
500706	53N64S COLLET FOR GAS LENS 2.4MM 24/24W	23 mm	5



PART NUMBER	DESCRIPTION	SIZE	PACK QTY
506002	0315021 COLLET 1.6MM 121/301	57 mm	5
506004	0315022 COLLET 2.4MM 121/301	57 mm	5
506006	0315023 COLLET 3.2MM 121/301	57 mm	5
506008	0315024 COLLET 4.0MM 121/301	57 mm	5



PART NUMBER	DESCRIPTION	SIZE	PACK QTY
502552	0314101 COLLET 1.6MM 450	36.5 mm	5
502554	0314102 COLLET 2.4MM 450	36.5 mm	5
502556	0314103 COLLET 3.2MM 450	36.5 mm	5
502558	0314104 COLLET 4.0MM 450	36.5 mm	5
502560	0314105 COLLET 4.8MM 450	36.5 mm	5

HIGH-RELIABILITY



TIG WEAR PARTS

COLLETS BODIES



PART NUMBER	DESCRIPTION	SIZE	PACK QTY
500752	13N26 COLLET BODY 1.0MM 9/20/25F/30	21 mm	5
500754	13N27 COLLET BODY 1.6MM 9/20/25F/30	21 mm	5
500756	70067 COLLET BODY 2.0MM 9/20/25F/30	21 mm	5
500758	13N28 COLLET BODY 2.4MM 9/20/25F/30	21 mm	5
500760	13N29 COLLET BODY 3.2MM 9/20/25F/30	21 mm	5



PART NUMBER	DESCRIPTION	SIZE	PACK QTY
500764	10N30 COLLET 1.0MM 17/18/26	47 mm	5
500766	10N31 COLLET 1.6MM 17/18/26	47 mm	5
500768	70064 COLLET 2.0MM 17/18/26	47 mm	5
500770	10N32 COLLET 2.4MM 17/18/26	47 mm	5
500772	70065 COLLET 3.0MM 17/18/26	47 mm	5
500774	10N28 COLLET 3.2MM 17/18/26	47 mm	5
500776	406488 COLLET 4.0MM 17/18/26	47 mm	5

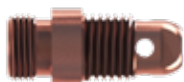

PART NUMBER	DESCRIPTION	SIZE	PACK QTY
500796	17CB24 COLLET STUBBY 3.2MM 17/18/26	24.3 mm	5



PART NUMBER	DESCRIPTION	SIZE	PACK QTY
500780	53N18 COLLET HD 1.0MM 24/24W	13 mm	5
500782	53N19 COLLET HD 1.6MM 24/24W	13 mm	5
500786	24CB332 COLLET HD 2.4MM 24/24W	13 mm	5

HIGH-QUALITY





TIG WEAR PARTS

GAS LENSES

TIG TORCHES

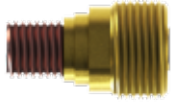

PART NUMBER	DESCRIPTION	SIZE	PACK QTY
500822	45V42 GAS LENS 1.0MM 9/20/24/24W/25F/30	22.5 mm	5
500824	45V43 GAS LENS 1.6MM 9/20/24/24W/25F/30	22.5 mm	5
500826	70058 GAS LENS 2.0MM 9/20/24/24W/25F/30	22.5 mm	5
500828	45V44 GAS LENS 2.4MM 9/20/24/24W/25F/30	22.5 mm	5
500830	45V45 GAS LENS 3.2MM 9/20/24/24W/25F/30	22.5 mm	5

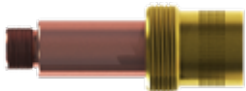

PART NUMBER	DESCRIPTION	SIZE	PACK QTY
500832	45V24 GAS LENS 1.0MM 17/18/26	50 mm	5
500834	45V25 GAS LENS 1.6MM 17/18/26	50 mm	5
500838	70060 GAS LENS 2.0MM 17/18/26	50 mm	5
500836	45V26 GAS LENS 2.4MM 17/18/26	50 mm	5
500842	70061 GAS LENS 3.0MM 17/18/26	50 mm	5
500840	45V27 GAS LENS 3.2MM 17/18/26	50 mm	5
500844	45V28 GAS LENS 4.0MM 17/18/26	50 mm	5

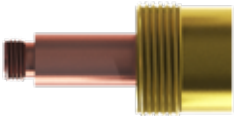

PART NUMBER	DESCRIPTION	SIZE	PACK QTY
500848	45V116 GAS LENS XL 1.6MM 17/18/26	50 mm	2
500850	45V64 GAS LENS XL 2.4MM 17/18/26	50 mm	2
500852	995795 GAS LENS XL 3.2MM 17/18/26	50 mm	2
500854	45V63 GAS LENS XL 4.0MM 17/18/26	50 mm	2



PART NUMBER	DESCRIPTION	SIZE	PACK QTY
500814	18GL16 GAS LENS 1.6MM 18SC	20.8 mm	5
500815	18GL32 GAS LENS 2.4MM 18SC	20.8 mm	5
500816	18GL18 GAS LENS 3.2MM 18SC	20.8 mm	5
500817	18GL53 GAS LENS 4.0MM 18SC	20.8 mm	5

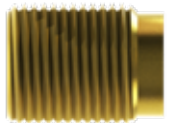

PART NUMBER	DESCRIPTION	SIZE	PACK QTY
506072	0316025 GAS LENS 1.6MM 121/301	23.8 mm	2
506074	0316026 GAS LENS 2.4MM 121/301	23.8 mm	2
506076	0316027 GAS LENS 3.2MM 121/301	23.8 mm	2
506078	0316028 GAS LENS 4.0MM 121/301	23.8 mm	2

HIGH-RELIABILITY



TIG WEAR PARTS

CERAMIC CUPS



HIGH-QUALITY



PART NUMBER	DESCRIPTION	SIZE	PACK QTY
500500	13N08 CERAMIC CUP 6.4MM 9/20/25F/30	14.5 X 30 mm	10
500502	13N09 CERAMIC CUP 7.9MM 9/20/25F/30	14.5 X 30 mm	10
500504	13N10 CERAMIC CUP 9.5MM 9/20/25F/30	14.5 X 30 mm	10
500506	13N11 CERAMIC CUP 11.1MM 9/20/25F/30	14.5 X 30 mm	10
500508	13N12 CERAMIC CUP 12.7MM 9/20/25F/30	14.5 X 30 mm	10
500510	13N13 CERAMIC CUP 15.9MM 9/20/25F/30	14.5 X 30 mm	10



PART NUMBER	DESCRIPTION	SIZE	PACK QTY
500520	10N50 CERAMIC CUP 6.4MM 17/18/26	17.3 X 47 mm	10
500522	10N49 CERAMIC CUP 7.9MM 17/18/26	17.3 X 47 mm	10
500524	10N48 CERAMIC CUP 9.5MM 17/18/26	17.3 X 47 mm	10
500526	10N47 CERAMIC CUP 11.1MM 17/18/26	17.3 X 47 mm	10
500528	10N46 CERAMIC CUP 12.7MM 17/18/26	17.3 X 47 mm	10
500530	10N45 CERAMIC CUP 16.0MM 17/18/26	17.3 X 47 mm	10
500532	10N44 CERAMIC CUP 19.0MM 17/18/26	17.3 X 47 mm	10



PART NUMBER	DESCRIPTION	SIZE	PACK QTY
500534	53N23 CERAMIC CUP 4.2MM 24/24W	15.5 X 17 mm	10
500536	53N24 CERAMIC CUP 6.4MM 24/24W	15.5 X 17 mm	10
500538	53N25 CERAMIC CUP 7.9MM 24/24W	15.5 X 17 mm	10
500540	53N27 CERAMIC CUP 9.5MM 24/24W	15.5 X 17 mm	10



PART NUMBER	DESCRIPTION	SIZE	PACK QTY
506202	0315035 CERAMIC CUP 9.8MM 121/301	20.5 X 46.3 mm	10
506204	0315037 CERAMIC CUP 11.1MM 121/301	20.5 X 46.3 mm	10



PART NUMBER	DESCRIPTION	SIZE	PACK QTY
506282	0315033 CERAMIC CUP SHORT 8.0MM 121/301	20.5 X 38.1 mm	10
506284	0315034 CERAMIC CUP SHORT 9.8MM 121/301	20.5 X 38.1 mm	10
506286	0315036 CERAMIC CUP SHORT 11.1MM 121/301	20.5 X 38.1 mm	10



PART NUMBER	DESCRIPTION	SIZE	PACK QTY
502400	0314201 CERAMIC CUP 9.8MM 450	28 X 38 mm	10
502402	0314202 CERAMIC CUP 12.7MM 450	28 X 38 mm	10
502404	0314203 CERAMIC CUP 15.9MM 450	28 X 38 mm	10





TIG WEAR PARTS

CERAMIC GAS LENS CUPS



PART NUMBER	DESCRIPTION	SIZE	PACK QTY
500560	53N58 CERAMIC GAS LENS CUP 6.4MM 9/20/24W/25F/30	19 X 25 mm	10
500562	53N59 CERAMIC GAS LENS CUP 7.9MM 9/20/24W/25F/30	19 X 25 mm	10
500564	53N60 CERAMIC GAS LENS CUP 9.5MM 9/20/24W/25F/30	19 X 25 mm	10
500566	53N61 CERAMIC GAS LENS CUP 11.1MM 9/20/24W/25F/30	19 X 25 mm	10
500568	53N61S CERAMIC GAS LENS CUP 12.7MM 9/20/24W/25F/30	19 X 25 mm	10



PART NUMBER	DESCRIPTION	SIZE	PACK QTY
500580	54N18/0315080 CERAMIC GAS LENS CUP 6.4MM 17/18/18SC/26/121/301	24.3 X 42 mm	10
500582	54N17/0315081 CERAMIC GAS LENS CUP 8.0MM 17/18/18SC/26/121/301	24.3 X 42 mm	10
500584	54N16/0315082 CERAMIC GAS LENS CUP 9.5MM 17/18/18SC/26/121/301	24.3 X 42 mm	10
500586	54N15/0315083 CERAMIC GAS LENS CUP 11.1MM 17/18/18SC/26/121/301	24.3 X 42 mm	10
500588	54N14/0315084 CERAMIC GAS LENS CUP 12.7MM 17/18/18SC/26/121/301	24.3 X 42 mm	10
500590	54N19 CERAMIC GAS LENS CUP 17.5MM 17/18/18SC/26/121/301	24.3 X 42 mm	10



PART NUMBER	DESCRIPTION	SIZE	PACK QTY
500638	57N75 CERAMIC GAS LENS CUP XL 9.5MM 17/18/26	30 X 48 mm	5
500636	57N74 CERAMIC GAS LENS CUP XL 12.7MM 17/18/26	30 X 48 mm	5
500592	53N88 CERAMIC GAS LENS CUP XL 16.0MM 17/18/26	30 X 48 mm	5
500594	53N87 CERAMIC GAS LENS CUP XL 19.0MM 17/18/26	30 X 48 mm	5
500596	53N89 CERAMIC GAS LENS CUP XL 23.8MM 17/18/26	30 X 48 mm	5



PART NUMBER	DESCRIPTION	SIZE	PACK QTY
502450	0314301 CERAMIC GAS LENS CUP 9.8MM 450	30 X 39.3 mm	10
502452	0314302 CERAMIC GAS LENS CUP 12.7MM 450	30 X 39.3 mm	10
502454	0314303 CERAMIC GAS LENS CUP 19.9MM 450	30 X 39.3 mm	10

HIGH-RELIABILITY



8XT SWITCH MODULE OPTIONS



PART NO.	DESCRIPTION	PACK QTY
8X9510	1-BUTTON SWITCH COMPLETE - MOMENTARY SWITCH	1



PART NO.	DESCRIPTION	PACK QTY
8X9560	LAMELLE SWITCH COMPLETE - MOMENTARY SWITCH	1



PART NO.	DESCRIPTION	PACK QTY
8X9520	2-BUTTON SWITCH COMPLETE MOMENTARY SWITCH WITH UP / DOWN APPLICATION	1



PART NO.	DESCRIPTION	PACK QTY
8X9530	3-BUTTON SWITCH COMPLETE MOMENTARY OR LATCHING SWITCH WITH UP / DOWN APPLICATION	1

HIGH-QUALITY





8XT SWITCH MODULE OPTIONS



PART NO.	DESCRIPTION	PACK QTY
8X9550	4-BUTTON ROCKER SWITCH COMPLETE LATCHING SWITCH WITH UP / DOWN APPLICATION	1



PART NO.	DESCRIPTION	PACK QTY
8X9570	1-BUTTON POTENTIOMETER SWITCH 10 KOHM COMPLETE MOMENTARY SWITCH WITH POTENTIOMETER	1



PART NO.	DESCRIPTION	PACK QTY
8X9571	2-BUTTON POTENTIOMETER SWITCH 10 KOHM COMPLETE MOMENTARY SWITCH WITH POTENTIOMETER	1

HIGH-RELIABILITY



8XT SWITCH CABLE ENDS



SWITCH CABLE ENDS

HIGH-QUALITY

CONFIGURATION SHEET

With this configuration sheet, you can easily select the plug applicable for the various welding machines. You can also select the switch types and water- or gas-cooled applications.

ITEM	PART NO.	MACHINE BRAND	PLUG TYPE	GAS COOLED	WATER COOLED	ONE BUTTON	TWO BUTTON	THREE BUTTON	FOUR BUTTON	ONE BUTTON POT
1	507541	Cebora	10-pins Cebora	☑	☑	☑		☑		
	507549	Cebora	10-pins Cebora	☑	☑	☑				☑
2	507450	Esab	2-pins Amphenol	☑	☑	☑				
3	5004623	EWM	5-pins Tüchel	☑	☑	☑	☑			
4	507714	EWM	8-pins UTG	☑	☑	☑	☑	☑	☑	
3	507552	Jäckle	5-pins Tüchel	☑	☑	☑	☑			
	507550	Jäckle	5-pins Tüchel	☑	☑	☑		☑	☑	
5	507561	Jäckle	7-pins Tüchel	☑	☑					☑
6	50048227	Fronius	9-pins Fronius	☑	☑	☑	☑	☑		
	50048247	Fronius	9-pins Fronius	☑	☑				☑	
7	507435	Kemppi	4-pins Amphenol	☑	☑	☑				
8	5075371	Kemppi	7-pins Amphenol MLS	☑		☑		☑		
	5075372	Kemppi	7-pins Amphenol MLS		☑	☑		☑		
	5075373	Kemppi	7-pins Amphenol MLS	☑						☑
	5075374	Kemppi	7-pins Amphenol MLS		☑					☑
9	507611	Migatronic	7-pins Amphenol	☑		☑				☑
	507621	Migatronic	7-pins Amphenol		☑	☑				☑
9	507612	Rehm	7-pins Amphenol	☑		☑	☑			
	507613	Rehm	7-pins Amphenol		☑	☑	☑			
	507615	Rehm	7-pins Amphenol	☑	☑					☑



TIG TOOLS & ACCESSORIES

EARTH CLAMPS | CABLE CONNECTORS



EARTH CLAMPS



PART NUMBER	DESCRIPTION	PACK QTY
430012	Earth clamp 200Amp	1



PART NUMBER	DESCRIPTION	PACK QTY
430015	Earth clamp 400Amp	1



PART NUMBER	DESCRIPTION	PACK QTY
430017	Earth clamp 600Amp	1

CABLE CONNECTIONS



PART NUMBER	DESCRIPTION	PACK QTY
305150	Cable connector plug (male) 10-25mm ²	2
305152	Cable connector plug (male) 35-50mm ²	2
305154	Cable connector plug (male) 50-70mm ²	2
305156	Cable connector plug (male) 70-95mm ²	2



PART NUMBER	DESCRIPTION	PACK QTY
305160	Cable connector plug (female) 10-25mm ²	2
305162	Cable connector plug (female) 35-50mm ²	2
305164	Cable connector plug (female) 50-70mm ²	2
305166	Cable connector plug (female) 70-95mm ²	2



PART NUMBER	DESCRIPTION	PACK QTY
305170	Panel socket (female) 10-25mm ²	2
305172	Panel socket (female) 35-50mm ²	2
305176	Panel socket (female) 70-95mm ²	2

HIGH-RELIABILITY



TIG TOOLS & ACCESSORIES

ELECTRODE HOLDERS | TUNGSTEN ELECTRODES



ELECTRODE HOLDERS



PART NUMBER	DESCRIPTION	PACK QTY
306580	Electrode holder Economy/crocodile type 200 AMP	1
306606	Electrode holder Economy/crocodile type 400 AMP	1
306640	Electrode holder Economy/crocodile type 600 AMP	1



PART NUMBER	DESCRIPTION	PACK QTY
306600	Electrode holder Optimum type 300 AMP	1
306610	Electrode holder Optimum type 400 AMP	1
306660	Electrode holder Optimum type 600 AMP	1



PART NUMBER	DESCRIPTION	PACK QTY
306615	Electrode holder (screw) Progress type 200 AMP	1
306620	Electrode holder (screw) Progress type 400 AMP	1
306650	Electrode holder (screw) Progress type 600 AMP	1

TUNGSTEN ELECTRODES

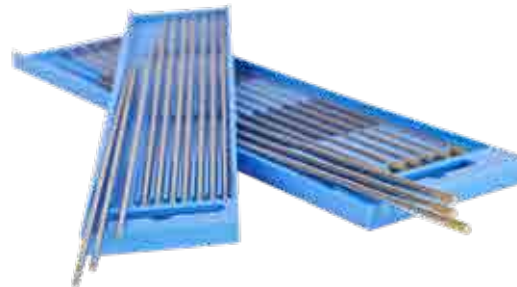

PART NUMBER	DESCRIPTION	PACK QTY
GREEN (WP = PURE)		
401000	TUNGSTEN ELECTRODES GREEN 175MM 1,0MM	10
401010	TUNGSTEN ELECTRODES GREEN 175MM 1,6MM	10
401020	TUNGSTEN ELECTRODES GREEN 175MM 2,0MM	10
401030	TUNGSTEN ELECTRODES GREEN 175MM 2,4MM	10
401037	TUNGSTEN ELECTRODES GREEN 175MM 3,0MM	10
401040	TUNGSTEN ELECTRODES GREEN 175MM 3,2MM	10
GREY (WC20 = 2% CERIATED)		
401180	TUNGSTEN ELECTRODES GREY 175MM 1,0MM	10
401190	TUNGSTEN ELECTRODES GREY 175MM 1,6MM	10
401195	TUNGSTEN ELECTRODES GREY 175MM 2,0MM	10
401200	TUNGSTEN ELECTRODES GREY 175MM 2,4MM	10
401205	TUNGSTEN ELECTRODES GREY 175MM 3,0MM	10
401210	TUNGSTEN ELECTRODES GREY 175MM 3,2MM	10
GOLD (WL15 = 1.5% LANTHANUM)		
401442	TUNGSTEN ELECTRODES GOLD 175MM 1,6MM	10
401441	TUNGSTEN ELECTRODES GOLD 175MM 2,4MM	10
401443	TUNGSTEN ELECTRODES GOLD 175MM 3,2MM	10
BLUE (WL20 = 2% LANTHANUM)		
401400	TUNGSTEN ELECTRODES BLUE 175MM 1,6MM	10
401410	TUNGSTEN ELECTRODES BLUE 175MM 2,4MM	10
401420	TUNGSTEN ELECTRODES BLUE 175MM 3,2MM	10

HIGH-QUALITY



▶ BY WELDERS. FOR WELDERS



+31 (0)30 - 604 73 73



Fahrenheitbaan 2
3439 MD Nieuwegein
The Netherlands



info@translas.com

www.translas.com

EUROPE

UNITED KINGDOM

NORTH AMERICA

